

## PREFACE

Thank you for selecting a Hero MotoCorp **XPULSE 200 PROGRAMMED FI**. We wish you many miles of continued riding pleasure in the years ahead.

We at Hero MotoCorp, are committed to demonstrate excellence in our environment performance on a continual basis, as an intrinsic element of our corporate philosophy. To achieve this we commit ourselves to continue product innovations to improve environment compatibility, comply with all applicable legislation including environment legislation and strengthen the green supply chain.

Your vehicle is conforming to latest (Bharat stage-VI norms) regulation for emission, safety & noise levels. We are also using non asbestos brake shoes/pads and engine gaskets which are environment friendly in nature.

This vehicle is fitted with a lighting feature known as “Automatic Headlamp ON”. The feature is mandated for all 2 Wheelers by Ministry of Road Transport & Highways (Government of India) vide notification GSR 188 (E) dated 22nd February 2016. This feature helps in conspicuity for improving rider safety. The headlamp of this vehicle will always be lit ON when the engine gets ON.

This booklet is your guide to the basic operation and maintenance of your new Hero MotoCorp **XPULSE 200 PROGRAMMED FI**. Please take time to read it carefully. As with any fine machine, proper care and maintenance are essential for trouble-free operation and optimum performance.

Your Authorised Hero MotoCorp dealer will be glad to provide further information or assistance and is equipped to handle your future service needs.

Let us make this world a safer, healthier and more environment friendly place.

 **NOTE**

**ALL INFORMATION, ILLUSTRATION, PHOTOGRAPH, DIRECTIONS, SPECIFICATIONS AND OTHER CONTENTS COVERED IN THIS OWNER'S MANUAL ARE BASED ON THE LATEST PRODUCT INFORMATION AVAILABLE AT THE TIME OF ITS PRINTING APPROVAL, AND THE ACCURACY OR CORRECTNESS OF THE SAME IS NOT UNDERTAKEN OR GUARANTEED.**

Hero MotoCorp Ltd **RESERVES THE RIGHT TO MAKE CHANGES IN ITS CONTENTS AT ANY TIME WITHOUT NOTICE AND/OR INCURRING ANY OBLIGATION, WHATSOEVER. NO ONE IS ALLOWED TO REPRODUCE ANY PART OF THIS PUBLICATION WITHOUT OBTAINING PRIOR WRITTEN PERMISSION FROM** Hero MotoCorp Ltd.

**ACCESSORIES SHOWN MAY NOT BE THE PART OF STANDARD FITMENT. IT IS OUR ENDEAVOUR TO CONSTANTLY IMPROVE OUR PRODUCTS. THIS COULD LEAD TO CHANGE IN PRODUCT SPECIFICATIONS WITHOUT NOTICE.** Hero MotoCorp Ltd **'XPULSE 200 PROGRAMMED FI' COMPLIES WITH THE LATEST EMISSION NORMS.**

## **ADDENDUM**

**As per Ministry of Road Transport & Highways (Government of India) vide Notification G.S.R. 540(E), Hemostatic agent is excluded from first aid kit in reduction from existing kit effective from 31st August 2020.**

# CONTENTS

	Pg. No.		Pg. No.
VEHICLE IDENTIFICATION	1	MAINTENANCE SCHEDULE	45
VEHICLE VIEWS	2	SPARK PLUG INSPECTION	48
VEHICLE SPECIFICATION	7	ENGINE OIL	49
VEHICLE SAFETY	9	OIL FILTER SCREEN & CENTRIFUGAL FILTER	
• Important safety information	9	CLEANING	50
• Protective apparel	10	ENGINE OIL COOLER	52
• Off-road safety	11	AIR CLEANER	52
• Load limits and guidelines	11	VALVE CLEARANCE ADJUSTMENT	54
• Accessories & modifications	13	CLUTCH LEVER FREE PLAY	55
ANTI-THEFT TIPS	13	THROTTLE OPERATION	56
SAFE RIDING TIPS	14	DRIVE CHAIN SLACKNESS	57
TIPS FOR HEALTHY ENVIRONMENT	15	DRIVE CHAIN SLIDER INSPECTION	60
PART FUNCTION	16	BRAKES	60
• Ignition switch	16	SUSPENSION	63
• Instruments and indicators	17	WHEEL	64
• LCD panel	19	MAIN STAND (OPTIONAL)/	
FEATURES	23	SIDE STAND LUBRICATION	66
HANDLEBAR SWITCHES CONTROL	30	TYRES	66
ABS INDICATOR	32	NUT, BOLTS & FASTENERS	68
SIDE STAND INDICATOR/SWITCH	32	BATTERY	69
FUEL TANK	34	FUSE REPLACEMENT	70
SEAT LOCK	35	STOP LAMP SWITCH	71
HELMET HOLDER	35	HEADLAMP FOCUS ADJUSTMENT	72
USB CHARGER	35	CATALYTIC CONVERTER	72
PRE-RIDE INSPECTION	36	EVAPORATIVE EMISSION CONTROL SYSTEM	73
STARTING THE ENGINE	37	POLISHING OF VEHICLE	73
RIDING	39	BASIC TROUBLESHOOTING	74
BRAKING	39	ROAD SIGNS	77
PARKING/TOOL KIT	41	NAVIGATION SIGNS	79
FIRST AID KIT	42	WARRANTY	
CLEANING AND WASHING OF VEHICLE	42	HERO GENUINE PARTS	
MAINTENANCE	43	ZONAL/REGIONAL/AREA OFFICES	
SAFETY PRECAUTION	44		

## VEHICLE IDENTIFICATION



### Vehicle Identification Number (VIN)

Location: Stamped on the right side of the steering head tube.

### Engine No.

Location: Stamped on the lower side of the left crankcase.

**VIN: MBLDL05#####**

<b>MBL</b>	<b>LDL05</b>	<b>#</b>	<b>#</b>	<b>#</b>	<b>#</b>	<b>#####</b>
Manufacturer code	Vehicle Description	Check Digit	Model Year	Plant Code	Month of Manufacturing	Production Serial Number

**Engine No.: MC20AG#####**

<b>MC20AG</b>	<b>#</b>	<b>#</b>	<b>#</b>	<b>#####</b>
Engine Description	Year of Manufacturing	Assembly Plant	Month of Manufacturing	Serial Number

**Model: XPULSE 200 PROGRAMMED FI**

<b>Variants</b>	<b>VIN</b>	<b>Engine</b>
Electric start/Front disc with ABS/Rear disc/Spoke wheel	LDL05	MC20AG

### VIN and Engine No. may be required:

- During registration of the vehicle.
- For dealing with legal & insurance departments.

## FRONT VIEW

## VEHICLE VIEWS



- (1) Leg guard
- (2) Headlamp (High beam)
- (3) Right position lamp
- (4) Front right turn signal lamp
- (5) Right hand guard
- (6) Wind screen

- (7) Left hand guard
- (8) Headlamp (Low beam)
- (9) Front left turn signal lamp
- (10) Left position lamp
- (11) Engine oil cooler

**\*Accessories and features shown may not be part of standard fitment.**

## REAR VIEW



(1) Rear fender

(2) Rear reflex reflector

(3) Left rear turn signal lamp

(4) Tail/stop lamp

(5) Licence plate lamp

(6) Right rear turn signal lamp

**\*Accessories and features shown may not be part of standard fitment.**

## TOP VIEW

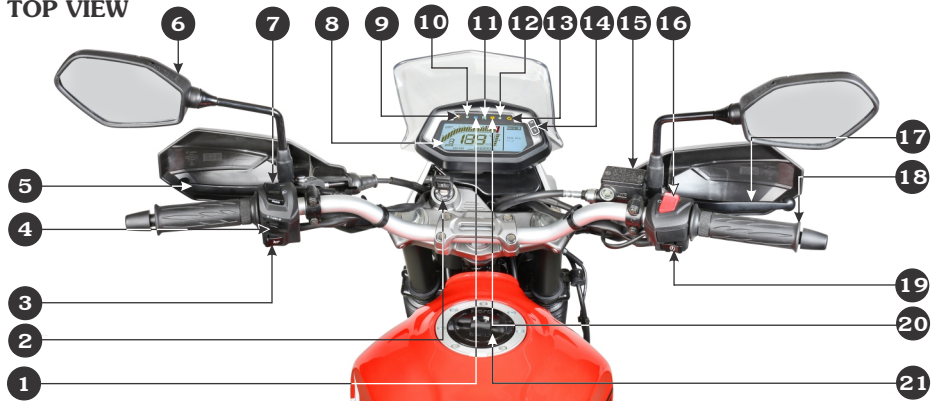

- |   |   |
|---|---|
| (1) High beam indicator   | (11) Neutral indicator                              |
| (2) Ignition switch with key  | (12) Right turn signal indicator                    |
| (3) Horn switch   | (13) Programmed FI malfunction indicator lamp (MIL) |
| (4) Turn signal switch  | (14) Mode (M) and Set (S) buttons                   |
| (5) Clutch lever  | (15) Front brake master cylinder/Reservoir          |
| (6) Rear view mirrors   | (16) Engine stop/kill switch                        |
| (7) Pass lamp switch  | (17) Front brake lever                              |
| (8) LCD panel of Meter console. refer instruments and indicators <b>(page 17)</b> for fuel gauge, speedometer and other features of console | (18) Throttle grip                                  |
| (9) Side stand indicator  | (19) Electric starter switch                        |
| (10) Left turn signal indicator   | (20) ABS indicator                                  |
|   | (21) Fuel tank cap                                  |

**\*Accessories and features shown may not be part of standard fitment.**



## LEFT SIDE VIEW



- |                           |                       |                                   |
|---------------------------|-----------------------|-----------------------------------|
| (1) Side reflex reflector | (7) Side stand        | (12) Seat                         |
| (2) Front hugger fender   | (8) Pillion foot rest | (13) Left side cover              |
| (3) Starter motor         | (9) Saree guard       | (14) Battery compartment (inside) |
| (4) Gear shift pedal      | (10) Seat lock        | (15) Side stand switch            |
| (5) Rider footrest        | (11) Rear grip        | (16) Front fender                 |
| (6) Main stand (optional) |                       |                                   |

**\*Accessories and features shown may not be part of standard fitment.**

## RIGHT SIDE VIEW



- |                                |   |
|--------------------------------|---|
| (1) Rear caliper assembly      | (9) Front disc  |
| (2) Rear brake fluid reservoir | (10) Throttle body                                    |
| (3) Kick starter pedal         | (11) Right side cover                                 |
| (4) Rear brake master cylinder | (12) Tool kit compartment (inside)                    |
| (5) Brake pedal                | (13) USB charger & First aid kit compartment (inside) |
| (6) Bash plate                 | (14) Air cleaner assembly (inside)                    |
| (7) Oil level dipstick         | (15) Exhaust muffler assembly                         |
| (8) Front caliper assembly     | (16) Rear disc  |

**\*Accessories and features shown may not be part of standard fitment.**

## VEHICLE SPECIFICATION

ITEM	SPECIFICATIONS	
<b>Dimensions</b>		
Overall length	2222 mm	
Overall width	850 mm	
Overall height	1258 mm	
Wheelbase	1410 mm	
Saddle height	823 mm	
Ground clearance	220 mm	
<b>Weight</b>		
Kerb weight	157 kg	
Pay load	130 kg	
<b>Capacities</b>		
Engine oil	1360 ml at disassembly and 1170 ml at draining	
Fuel tank capacity	13.0 litres	
Hydraulic brake fluid	DoT-4/DoT-3	
<b>Engine</b>		
Maximum power	13.3 kW @ 8500 r/min	
Maximum torque	16.45 N-m @ 6500 r/min	
Bore and stroke	66.5x57.5 mm	
Compression ratio	10:01	
Displacement	199.6 cc	
Spark plug	NGK-CPR 8 EA9	
Spark plug gap	0.8-0.9 mm	
Valve clearance	Intake (cold)	0.07 mm +0.01/-0.02
	Exhaust (cold)	0.09 mm +0.01/-0.02
Idle speed	1400±100 r/min	
<b>Chassis and suspension</b>		
Front suspension	Telescopic front forks (dia 37 mm) with anti friction bush	
Rear suspension	Rectangular swingarm with mono shock	
Caster angle	27°	
Trail length	114 mm	

## VEHICLE SPECIFICATION

ITEM		SPECIFICATIONS
Tyre size	Front	90/90-21 M/C 54S
	Rear	120/80-18 M/C 62S
Brakes	Front (Disc type)	Dia. 276 mm
	Rear (Disc type)	Dia. 220 mm
<b>Transmission</b>		
Primary reduction		3.350 (67/20)
Final reduction		2.923 (38/13)
Transmission		5 speed constant mesh
Gear ratio, 1 <sup>st</sup>		3.0769 (40/13)
2 <sup>nd</sup>		1.7895 (34/19)
3 <sup>rd</sup>		1.500 (30/20)
4 <sup>th</sup>		1.100 (22/20)
5 <sup>th</sup>		0.9583 (23/24)
<b>Electricals</b>		
Battery		*MF Battery 12V-6 Ah/ETZ-7
Alternator		252 W @ 5000 r/min
Headlamp		12V-5.6W/9.3W (LED)
Position lamp		12V-0.9W (LED)
Tail/Stop lamp		12V-0.2/2.1W (LED)
Turn signal lamp		12V-10Wx4 nos. **MFR (Amber bulb-clear lens)
Meter illumination		Module illuminated LCD
Neutral indicator		LED
Turn signal indicator (RH/LH)		LEDx2 nos.
Hi beam indicator		LED
ABS indicator		LED
Service reminder indicator		LCD display
Programmed-Fi malfunction indicator lamp (MIL)		LED
Licence plate lamp		12V-5W
Side stand indicator		LED
Fuse	Starter magnetic switch	20A (Circuit fuse) and 20A (Spare fuse)
	Fuse box	15A, 10A, 10A, 10A (Circuit fuse) & 15A, 10A (Spare fuse)

\*MF stands for Maintenance Free

\*\*MFR stands for Multi-Focal Reflector type

## VEHICLE SAFETY IMPORTANT SAFETY INFORMATION

Your vehicle can provide many years of service and pleasure if you take responsibility for your own safety and understand the challenges you can meet on the road.

There is much that you can do to protect yourself when you ride. You will find many helpful recommendations through out this manual. Following are a few that we consider most important.

### **Always wear a helmet**

It is a proven fact, helmet significantly reduces the number and severity of head injuries. So always wear a helmet and make sure your pillion rider does the same. We also recommend that you wear eye protection, sturdy boots, gloves and other protective gear.

### **Before riding your vehicle**

Make sure that you are physically fit, mentally focused and free of alcohol and drugs. Check that you and your pillion are both wearing an approved vehicle helmet and protective apparel. Instruct your pillion on holding onto the grab rail or your waist, leaning with you in turns, and keeping their feet on the footrest, even when the vehicle is stopped.

### **Take time to learn & practice your vehicle**

Even if you have ridden other vehicles, practice riding in a safe area to become familiar with how this vehicle works and handles, and to become accustomed to the vehicle's size and weight.

### **Ride defensively**

Always pay due attention to other vehicles around you, and do not assume that other drivers see you. Be prepared to stop quickly or perform an evasive maneuver.

### **Make yourself easily visible**

Some drivers do not see vehicles because they are not looking for them. To make yourself more visible, wear bright reflective clothing, position yourself so that others can see you, signal before turning or changing lanes, and use horn which will help others to notice you.

### **Ride within your limits**

Pushing the limits is another major cause of vehicle accidents. Never ride beyond your personal abilities or faster than conditions demand. Remember that fatigue and negligence can significantly reduce your ability to make good judgements and ride safely.

### **Do not drink and ride**

Riding under the influence of alcohol or drugs is dangerous. Alcohol can reduce your ability to respond to changing conditions and reduce the reaction time. Do not drink and ride.

### **Keep your vehicle in safe condition**

For safe riding, its important to inspect your vehicle before every ride and perform all recommended maintenance. Never exceed load limits, and use accessories that have been recommended by Hero MotoCorp for this vehicle. See **(page 1 1)** for more details.

## If you are involved in a crash

Personal safety is your first priority. If you or anyone else has been injured, take time to assess the severity of the injuries and whether it is safe to continue riding. Call for emergency assistance if needed. Also follow applicable laws and regulations if another person or vehicle is involved in the crash.

If you decide to continue riding, first evaluate the condition of your vehicle. If the engine is still running, turn it off. Inspect for fluid leaks, check the tightness of critical nuts and bolts, and check the handlebar, brake levers, brakes, and wheels. Ride slowly and cautiously. Your vehicle may have suffered damage that is not immediately apparent. Have your vehicle thoroughly checked at a qualified service facility as soon as possible.

## PROTECTIVE APPAREL

For your safety, we strongly recommend that you always wear an approved helmet (ISI marked), eye protection, boots, gloves, long pants and a long sleeve shirt or jacket whenever you ride. Take care of loose/hanging clothes while solo/pillion riding. Although complete protection is not possible, wearing proper gear can reduce the chance of injury when you ride.

Following are suggestions to help you choose proper riding gear.



## WARNING

- **Not wearing a helmet increases the chance of serious injury or death in a crash.**
- **Be sure you and your pillion always wear a helmet, eye protection and other protective apparel when you ride.**

## Helmet and eye protection

Your helmet is your most important piece of riding gear because it offers the best protection against head injuries. A helmet should fit your head comfortably and securely. A bright coloured helmet can make you more noticeable in traffic, as can reflective strips.

An open-face helmet offers some protection, but a full-face helmet offers more. Always wear face shield or goggles to protect your eyes and help your vision.

## Additional riding gear

In addition to a helmet and eye protection, we also recommend:

- Sturdy boots with non-slip soles to help protect your feet and ankles.
- Leather gloves to keep your hands warm and help prevent blisters, cuts, burns, and bruises.
- A two wheeler riding suit or jacket for comfort as well as protection. Bright coloured reflective clothing can help make you more noticeable in traffic. Be sure to avoid loose clothes that could get caught on any part of your vehicle.

## OFF-ROAD SAFETY

This vehicle allows you to enjoy all the excitement of riding it off-road. For this, it is necessary to follow some recommendations, which will tie off-road excitement with safety.

### Protective equipment

Essential for your safety. Make a rule of always wearing them.

- **Helmet**- essential equipment.
- **Goggles**- the greater the visibility, the better.  
Choose goggles that do not break or splinter.
- **Long**- sleeved shirts having fillings in the elbows and shoulders to protect against eventual injuries in the arms.
- **Gloves**- models with padded hand backs are the most indicated for off-road riding. Choose gloves that fit your hands.
- **Adbominal band**- it protects internal organs against off-road bumps.
- Nylon trousers with protection in the knees or reinforced jeans. They increase protection. Choose the right size for your proper freedom of motion.
- **Boots**- they should be made of reinforced leather with thick grooved soles and steel tips. They should also be flexible and fit you properly.
- **Waist bag**- it is important so you may carry spare parts and those parts that were removed from the vehicle.

## Preparing the vehicle

For off-road practice, it is essential that your vehicle is in perfect mechanical condition. The front brake lever, clutch lever and turn signal brackets should be loosened in order to rotate in case of falling down, preventing breakage. They should be loosened to turn on the handlebars only with a slight force. Under most adverse conditions, the rear view mirrors and turn signals should be removed.

## LOAD LIMITS AND GUIDELINES

Your vehicle has been designed to carry you, one pillion and limited amount of cargo. When you add cargo or carry a passenger, you may feel some difference during acceleration and braking. But so long as you keep your vehicle well maintained, with good tyres and brakes, you can safely carry loads within the limits and guidelines.

However exceeding the weight limit or carrying an unbalanced load can seriously affect your vehicle's handling, braking and stability. Non Hero MotoCorp accessories, modifications, and poor maintenance can reduce your safety margin.

### Loading

How much weight you put on your vehicle, and how you load it, are important to your safety. Anytime you ride with a pillion or cargo you should be aware of the following information.

## **! WARNING**

- **Overloading or improper loading can cause a crash and you can be seriously injured.**
- **Follow all load limits and other loading guidelines in this manual.**

### **Load limits and weight distribution**

This vehicle is designed to carry the rider (1) and one pillion (2). The overall weight should be distributed in four points (A, B, C, and D) and should never exceed the maximum load capacity of **130 kg**. This will assure higher stability, better drivability and more comfort.

**(1)+(2)= 130 kg {where, 1=A+B & 2=C+D}**



**(A) Rider seat**  
**(C) Pillion seat**

**(B) Rider footrest**  
**(D) Pillion footrest**

Damages caused by excessive load will not be covered under Hero MotoCorp warranty policy. If you are not sure about how to calculate the load weight that can be accommodated to your vehicle without causing overload and structural damages, see your Authorised Hero MotoCorp workshop.

### **Loading guidelines**

Your vehicle is primarily intended for transporting you and a pillion. If you wish to carry cargo, check with your Authorised Hero MotoCorp workshop for advice and be sure to read the information regarding accessories on **(page 13)**.

Improperly loading your vehicle can affect its stability and handling. Even if your vehicle is properly loaded, you should ride at reduced speeds whenever carrying cargo.

Follow these guidelines whenever you carry a pillion or cargo:

- Keep cargo and accessory weight low and close to the center of the vehicle. Load weight equally on both sides to minimize imbalance. As weight is located further from the vehicle's center of gravity, handling is proportionally affected.
- Adjust tyre pressure **(page 64)** to suit load weight and riding conditions.
- Vehicle handling and stability can be adversely affected by loose cargo. Recheck cargo security and accessory mounts frequently.
- Do not attach large or heavy items to the handlebars, front fork or fender. Unstable handling or slow steering response may result.



## ACCESSORIES & MODIFICATIONS

Modifying your vehicle or using non-Hero MotoCorp accessories can make your vehicle unsafe. Before you consider making any modifications or adding an accessory, be sure to read the following information.



### WARNING

- ***Improper accessories or modifications can cause a crash in which you can be seriously hurt or killed.***
- ***Follow all instructions in this owner's manual regarding accessories and modifications.***

### Accessories

- Make sure that the accessory does not obscure any lamps, reduce ground clearance, limit suspension travel or steering travel, affect your riding position or interfere with operating any controls.
- Be sure electrical equipment does not exceed the vehicle's electrical system capacity (**page 8**). A blown fuse can cause a loss of lights.
- Do not pull a trailer or sidecar with your vehicle. This vehicle was not designed for these attachments, and their use can seriously impair your vehicle's handling.

### Modifications

We strongly advise you not to remove any original equipment or modify your vehicle in any way that would change its design or

operation. Such changes could seriously impair your vehicle's handling, stability and braking, making it unsafe to ride. Removing or modifying your lamps, mufflers, emission control system or other equipment can also make your vehicle illegal.

### ANTI-THEFT TIPS

- Always lock the steering and never leave the key in the ignition switch. This sounds simple but people do forgets.
- Be sure the registration information for your vehicle is accurate and correct.
- Park your vehicle in a locked garage whenever possible.
- Use an additional anti-theft device of good quality.
- Never park your vehicle in an isolated area. Park as far as possible in a designated area.
- Enter your name, address and phone number in this Owner's Manual and keep it in your vehicle at all times. Many times stolen vehicles are identified by information in the Owner's Manuals that are still with them.

**NAME:** \_\_\_\_\_

**ADDRESS:** \_\_\_\_\_

\_\_\_\_\_

\_\_\_\_\_

\_\_\_\_\_

**PHONE NO :** \_\_\_\_\_

## SAFE RIDING TIPS



### Do's:

- Always conduct simple pre-ride inspection (**page 35**).
- Always wear a helmet (ISI marked) with chin strap securely fastened and insist on a helmet for your pillion rider.
- While riding, sit in a comfortable position with your legs close to fuel tank.
- Ride defensively and at a steady speed (between 40–50 km/hr).
- For stopping vehicle, use both brakes simultaneously, keeping throttle in the close position.
- Respect road signs and obey traffic rules for your own safety and that of others on the road (**page 77**).
- During night time, dip headlamps of your vehicle for oncoming traffic, or when following another vehicle.
- Give way to others on the road and signal before you make a turn.
- To make yourself more visible, wear bright reflective clothing that fits well.
- Take care of loose/hanging clothes while solo/pillion riding.
- Get your vehicle serviced regularly by the Authorised Hero MotoCorp workshop.
- Before riding make sure that engine stop/kill switch is in “ON” (⊙) position.
- Keep checking the ABS indicator. At any point if indicator remains on, then ABS is not working (**page 32**).
- Keep checking speedometer. In case of ABS malfunction, speed display may go to zero.
- It is suggested to go through the do's & dont's of ABS (**page 40**) and practice your ABS vehicle initially in low-traffic condition unless you are thoroughly familiar with your vehicle and its controls.

### Don'ts

- Never use cell phone while riding the vehicle.
- Avoid sudden acceleration, braking and turning of your vehicle.
- Never shift gears without disengaging the clutch and closing the throttle.
- Never touch any part of the hot exhaust system like muffler.
- Never ride under the influence of alcohol or drugs.
- Concentrate on the road and avoid talking to the pillion rider or others on the road.
- Do not litter the road.
- Do not cross the continuous white/yellow line in the center of the road, while overtaking.
- Do not attach large or heavy items to the handlebars, front forks, or fenders.
- Never take your hands off the steering handle while riding.
- Do not attempt to apply the front brake lever intermittently for ABS vehicle.
- Do not panic by mechanical noises or slight lever pulses while applying the brake in vehicle. These conditions are normal and indicates that ABS is working.
- Do not apply the hard braking in wet or rainy conditions.
- Do not switch off the engine stop/kill switch while riding the vehicle (**page 31**).
- Do not move the side stand down while riding, as engine will stop while vehicle is in gear (**page 32**).
- Navigation system assists you to reach your destination, don't be distracted while driving. Drive safely and always obey traffic rules.

## TIPS FOR HEALTHY ENVIRONMENT

The following tips shall ensure a healthy vehicle, healthy environment, and a healthy you.

- **Healthy engine:** The engine is the lifeline of every vehicle. To keep it healthy, it should be tuned regularly, which will also help reduce pollution and improve vehicle performance & fuel efficiency.
- **Regular servicing:** Get your vehicle serviced at an Authorised Hero MotoCorp workshop, as per the service schedule, for an optimum performance and keep the emission level under check.
- **Genuine spares:** Always insist on Hero MotoCorp genuine parts as spurious or incompatible spares and accessories can upset or deteriorate your vehicle's running condition.
- **Genuine engine oil:** Hero 4T Plus SAE 10W 30 SL grade (JASO MA2) engine oil recommended by Hero MotoCorp and make sure you change it every **6000** km. (with top up every **3000** kilometres) to keep the engine fit and environment healthy.
- **Noise pollution:** Noise beyond a certain decibel is pollution. Whether it is from horns or defective mufflers, excessive noise will cause headaches and discomfort.
- **Emission pollution:** Get emission of your vehicle checked by Authorised agencies atleast once every **3** months or as notified by the government from time to time.
- **Fuel saving & reduce pollution:** Switch "OFF" the engine while waiting at traffic signal points to save fuel and reduce pollution, if the waiting period is long.
- **BS-VI grade fuel :** Always use BS-VI grade fuel to adhere BS-VI norms.

## PARTS FUNCTION IGNITION SWITCH

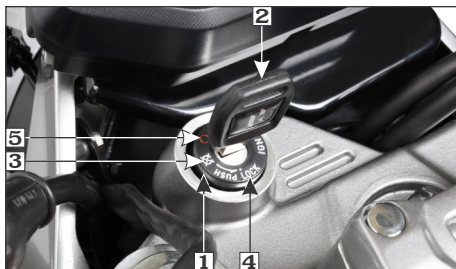
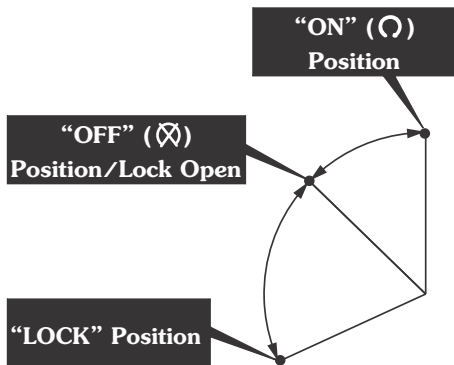

1. Ignition switch
2. Ignition key
3. "OFF" (∞) position
4. Steering lock position
5. "ON" (O) position

Key Position	Function	Key Removal
"ON" (O)	The LCD panel illuminates & initial display of multi function digital segments are displayed. The tachometer segment and the fuel gauge segment will swing to the maximum scale once and back to its normal position. The engine can be started. Turn signal lamp, horn, tail/stop lamp, fuel gauge, pass lamp, position lamp, programmed FI malfunction indicator lamp (MIL) illuminates continuously & neutral indicator will be functional.	Key cannot be removed.
"OFF" (∞)	Engine cannot be started and no electrical system will be functional.	Key can be removed.
"LOCK"	Steering can be locked.	Key can be removed.

## INSTRUMENTS AND INDICATORS

The indicators are in the speedometer panel above the headlamp. The functions are as below.

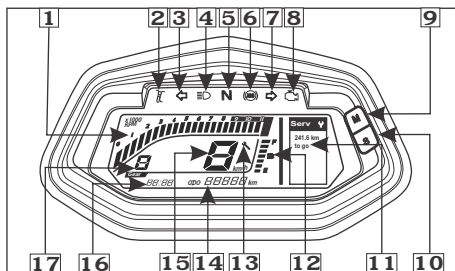

Sl. No.	Description	Function
1	Tachometer	Shows engine revolution per minute. The tachometer digital segments will swing to maximum scale on the meter console once the ignition switch is turned “ON” .
2	Side stand indicator	Light glows when the vehicle is parked on the side stand.
3	Turn signal indicator (L)	Flashes when left turn signal switch is operated.
4	High beam indicator	Light glows when headlamp is in high beam.
5	Neutral indicator	Light glows when vehicle is in neutral.
6	Anti-lock braking system (ABS) indicator	This indicator normally comes on for approx 1.8 seconds when the ignition switch is turned “ON” (⏻) & then keeps blinking until the vehicle attains speed of 5 km/h. If there is a problem with the anti-lock brake system, ABS indicator turns on ( <b>page 32</b> ).
7	Turn signal indicator (R)	Flashes when right turn signal switch is operated.

Sl. No.	Description	Function
8	Programmed-FI malfunction indicator lamp (MIL)	When the ignition switch is turned “ON” the programmed FI malfunction indicator lamp (MIL) glows continuously and then should go “OFF” once the engine is started. It indicates that programmed FI system is OK. If it glows continuously there is an abnormality in the programmed FI system, it is recommended to reduce the speed and drive to the Authorised Hero MotoCorp workshop for check-up.
9	Mode button	Switches display between odometer, tripmeter-1 & 2, clock, Eco mode & Bluetooth connectivity.
10	Set button	To adjust clock, date & tripmeter. When long pressed resets tripmeter to zero.
11	Next service distance	Indicates how many kilometers are left before the next service is due. It appears for few seconds when the ignition switch is turned “ON” (O) (page 22).
12	Fuel gauge	Indicates approximate fuel available in the form of digital segments. The digital segments will swing to maximum scale on the meter console once the ignition switch is turned “ON” (O) (page 22).
13	Service reminder indicator	Displays when the next service is due (page 22).
14	Odometer	Shows accumulated distance travelled (page 20).
15	Speedometer	Indicates riding speed.
16	Digital clock	Indicates hours & minutes (page 19).
17	Gear indicator	Displays the selected gear while riding (page 24).

## LCD PANEL

### (a) Digital clock

Digital clock (1) shows hour and minute. To adjust the time, proceed as follows :

- Turn the ignition switch "ON" (⊙).
- Press and hold set button (2) and mode button (3) simultaneously for more than 2 seconds. The clock will be set in the adjust mode with the hour's digit display blinking.

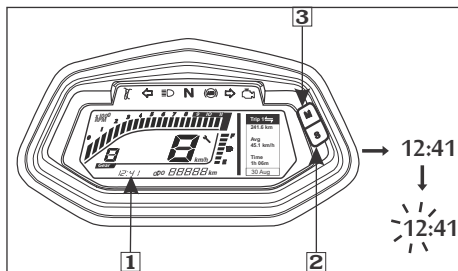

(1) Digital clock  
(3) Mode button

(2) Set button

- To set the hour, press set button (2) until the desired hour is displayed.
  - The time is advanced by 1 hour each time the button is pressed.
  - The time advances fast when the button is pressed and held.

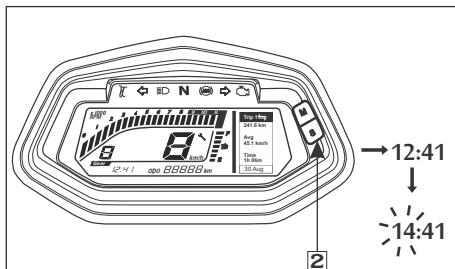

(2) Set button

- Press the mode button (3). The minutes display starts blinking.

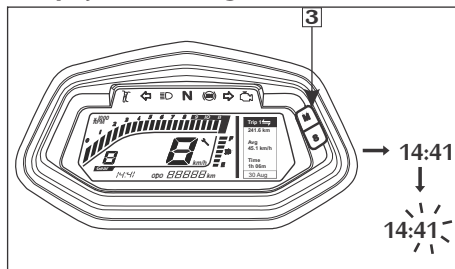

(3) Mode button

- To set the minute press set button (2) until the desired minute is displayed. The minute display will return to "00" when "60" is reached without affecting the hour display.
  - The time advances by 1 minute, each time the button is pressed.

- The time advances fast when the button is pressed and held.

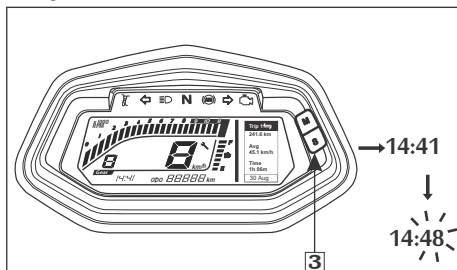

**(3) Mode button**

- To end the adjustment press the mode button (3) until clock display stops blinking.



### NOTE

**The clock will reset to "1:00" if the battery is disconnected.**

### (b) Odometer/Tripmeter

The odometer (1) shows accumulated distance travelled.

The tripmeter shows distance travelled since trip meter was reset last time. There are two tripmeters, "Trip-1" and "Trip-2".

Push the mode button (3) to select "Trip-1" and "Trip-2". "Trip-1" and "Trip-2" can be displayed upto "999.9" km.

If the tripmeter exceeds "999.9" km it will return to "0.0" km automatically.

Trip meter displays following parameters:

- **Distance:** distance covered in a trip.
- **Avg speed:** average speed at which vehicle completes a trip
- **Trip time:** time taken to complete a trip.
- **Date:** it shows the current date.

When tripmeter is selected, long press (more than 2 seconds) the set button to reset tripmeter to zero. The odometer can be displayed from "0 to 99999" km.

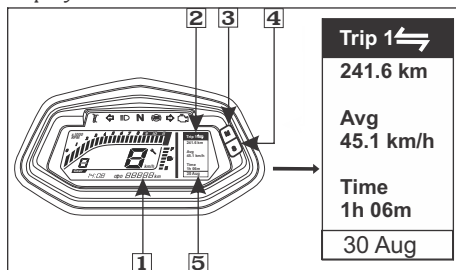

**(1) Odometer**

**(3) Mode button**

**(5) Date**

**(2) Tripmeter**

**(4) Set button**

To update the date proceed as follows :

- Turn the ignition switch "ON" (O).
- Press and hold set button (4) and mode button (3) simultaneously for more than 2 seconds. The clock display will start blinking (**page 19**).
- Keep pressing and releasing mode button (3) until date display (5) starts blinking.



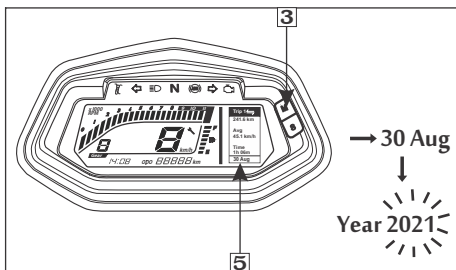

**(3) Mode button** **(5) Date display**

- Now to set year, press set button (4) until the desired year is displayed.

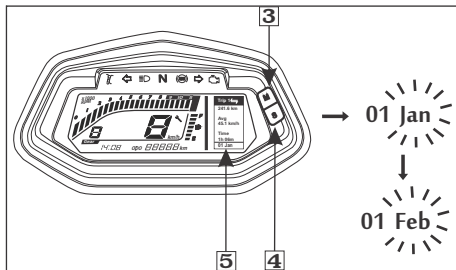

**(3) Mode button** **(4) Set button**  
**(5) Date display**

- To set day, press the mode button (3) to switch from month to day display. Now press the set button (4) until the desired day is displayed.

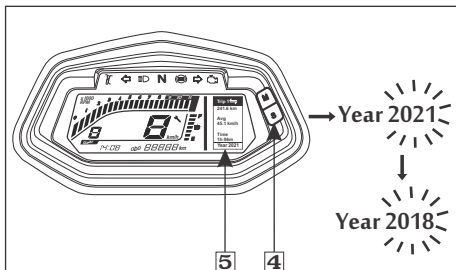

**(4) Set button** **(5) Date display**

- To set month, press the mode button (3) to switch from year to month display. Now press the set button (4) until the desired month is displayed.

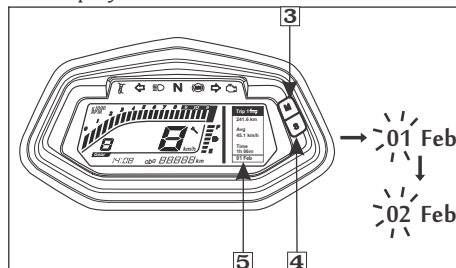

**(3) Mode button** **(4) Set button**  
**(5) Date display**

- To end the adjustment press the mode button until date display stops blinking.

### (c) Fuel gauge

The fuel gauge (1) indicates approximate fuel available in the form of digital segments.

The digital segments (2) will swing to maximum scale on the meter console once the ignition switch is turned "ON" (⊙). If all the segments are displayed it means fuel quantity in the fuel tank is 13.0 litres.

If only one segment (3) is displayed and blinks, this indicates the fuel quantity is low and the fuel tank should be refilled as soon as possible.

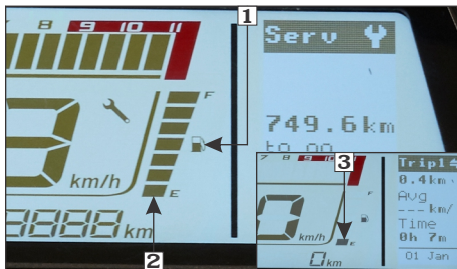

(1) Fuel gauge

(2) Segments

(3) One segment

### ! CAUTION

*Please ensure the vehicle is not used continuously when the fuel level indicator reaches the one segment blinking. It will not only result in the vehicle running out of fuel, it may also cause serious damage to the fuel pump. Please ensure fuel is filled up as soon as the fuel level indicator reaches one segment blinking.*



### NOTE

**To check the fuel level indication, the vehicle should be on levelled surface and in stationary condition.**

### (d) Service reminder indicator

The service reminder indicator (1) is to indicate the user to bring the vehicle to an Authorised Hero MotoCorp workshop for service. The indicator shall start blinking when the vehicle covers kilometers as specified in the maintenance schedule. The indicator will keep on blinking throughout the kilometer interval for a particular service and will stay "ON" thereafter.

Meter console also displays the next service distance (2). It indicates how many kilometers are left before the next service is due. It appears for few seconds when the ignition switch is turned "ON" (⊙).

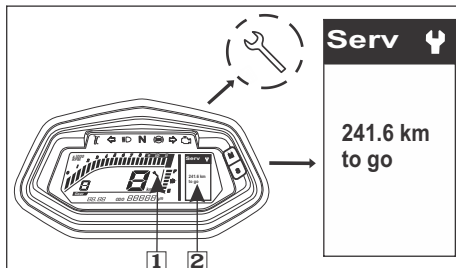

(1) Service reminder indicator

(2) Next service distance

The service reminder indicator “🔧” can be reset at an Authorised Hero MotoCorp workshop.



### NOTE

*After getting the vehicle serviced, make sure that the Service Reminder Indicator has been reset.*

## FEATURES

### (a) Engine stop/kill switch

The engine stop/kill switch (1) is provided next to throttle grip. The switch has two positions. In “ON” (⊙) position (2), engine will operate and in “OFF” (⊗) position (3), there will be a message “KILL SWITCH ON” (4) on the meter console and the engine will not operate.

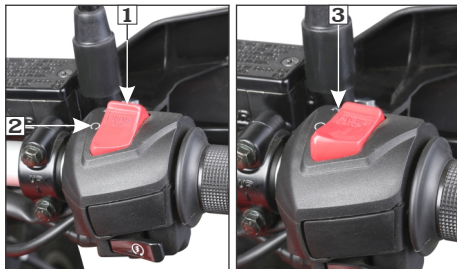

(1) Engine stop/kill switch  
 (2) “ON” position      (3) “OFF” position

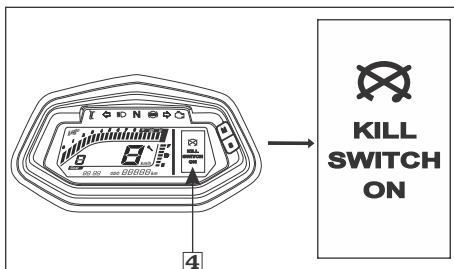

(4) Kill switch mode

### (b) ECO mode

ECO mode assists the rider to achieve optimum fuel efficiency. Press the mode button (1) until ECO mode (2) is displayed.

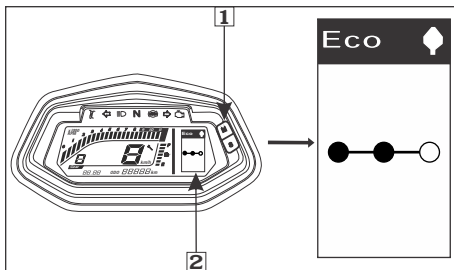

(1) Mode button      (2) Eco mode

It displays following riding instructions :

- Shift up indicator: it recommends for shifting to high gear.

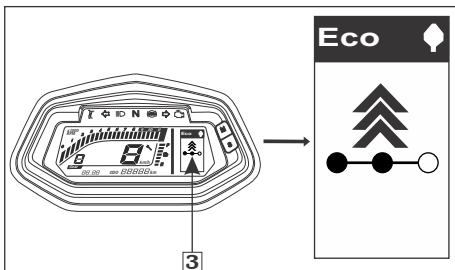

**(3) Shift up indicator**

- Shift down indicator: it recommends for shifting to low gear.

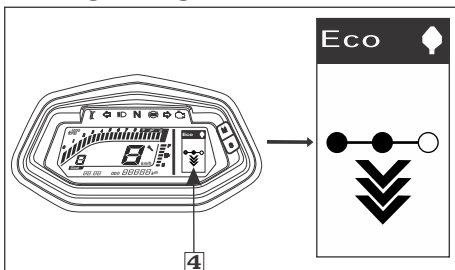

**(4) Shift down indicator**

 **NOTE**

*ECO mode assists the rider to achieve optimum fuel efficiency based on your vehicle's engine performance.*

*It is recommended to ride your vehicle as per road and traffic conditions.*

**(c) Gear indicator**

Gear indicator (1) indicates current gear condition of your vehicle in which it is running.

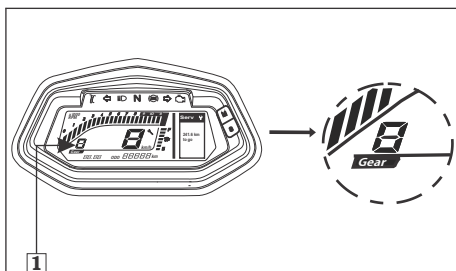

**(1) Gear indicator**

 **NOTE**

- Gear indicator displays "0" when your vehicle is in neutral.
- Gear indicator displays "-" when it delays in displaying the gear indication or when you change gears in vehicle static condition (vehicle is in main stand and ignition switch is in "ON" position).

**(d) Hero ride guide/Navigation**

**Application:**

Hero navigation application (1) is available in the google play store (for androids) or App Store (for iOS), which can be installed in your device to access bluetooth, incoming calls alerts, mobile low battery alert, and navigation features.



## NOTE

- **Compatibility and performance of hero ride guide application may vary based on your device and software version.**
- **Application needs GPS signal, internet and bluetooth connectivity to perform the desired navigation functionality.**

### Bluetooth:

Your vehicle is equipped with bluetooth connectivity feature by which you can pair your smartphone with the meter console of your **XPULSE 200 PROGRAMMED FI** vehicle through Hero navigation application.

To connect your device proceed as follows:

- Turn the ignition switch “ON”.
- Open hero navigation application (1) on your smartphone.

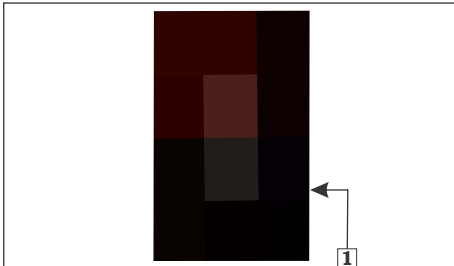

**(1) Hero navigation application**

- For first time pairing, allow the application to access:

- Device’s location if GPS is not enabled in your device
- Photos, media, files
- Contacts
- Make & manage phone calls
- Phone call logs on your device

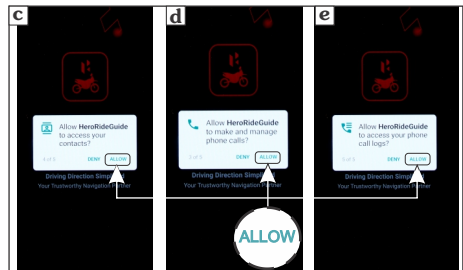
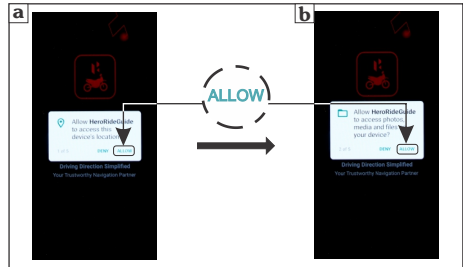

- Now select “GET STARTED” (2) to proceed.
- Application also asks you to accept (3) the terms of use to proceed.

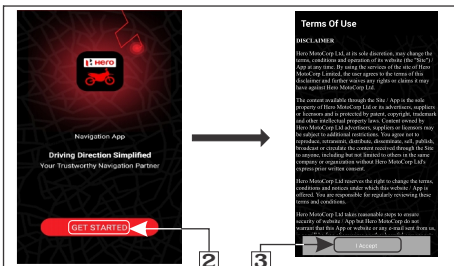

- (2) Get started  
(3) Accept terms of use

- Now select your bike (4).

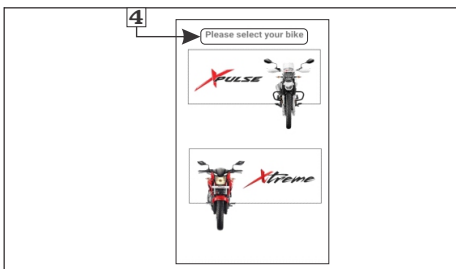

- (4) Select your bike

- The application searches for a while and displays all nearby devices. Select the device with your name (5).
- Update your name (6) (if required) and select either save and connect (7) or connect (8) to proceed.

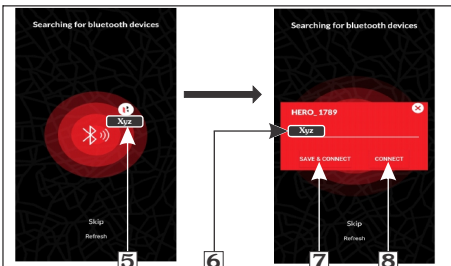

- (5) Select your device  
(6) Change your device name  
(7) Save and connect (8) Connect

- Now application ask for paring request (9).
- Now meter console will display paring pin (10)
- Enter the pin in navigation screen and select “Pair” (11)

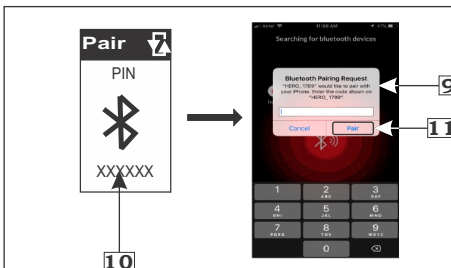

- (9) Pairing request (10) Pin (11) “Pair”

- On pairing, meter console displays “connected” (12) below bluetooth symbol in bluetooth mode (13).

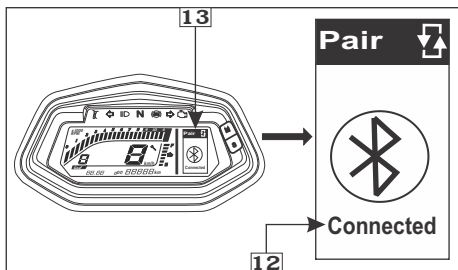

(12) Bluetooth connected  
(13) Bluetooth mode

- If any error occurs during the course of pairing process, then meter console will display “Not found” (14) below bluetooth symbol. Repeat the above steps and keep your smartphone closer to the vehicle to reconnect.

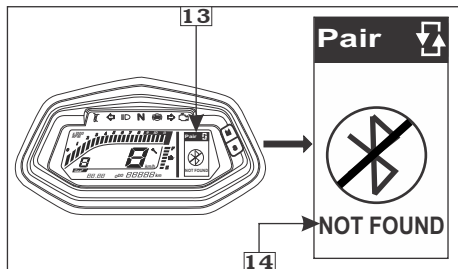

(13) Bluetooth mode (14) Not found

## Navigation:

To use navigation feature proceed as follows:

- Connect your vehicle with your hero ride guide/navigation application via bluetooth (page 25).
- After successful connection, the application and meter console display will automatically switch to navigation mode (4). It will also update your current location (1) through GPS system.
- Now choose your destination (2) through the application and select “start ride” (3).

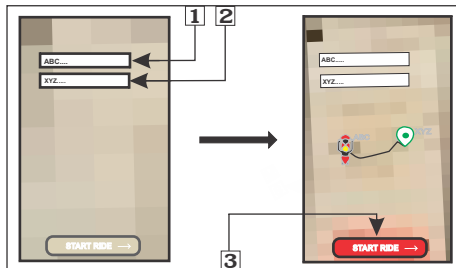

(1) Current location (2) Choose destination  
(3) Start ride

- After processing for a while, meter console will display the direction (5), distance for next move (7) and estimated time of arrival (ETA) (6). Estimated time of arrival will be displayed in “am” or “pm”. Hero navigation app and meter console of your vehicle will display step by step navigation guidance/direction through navigation signs (page 79).

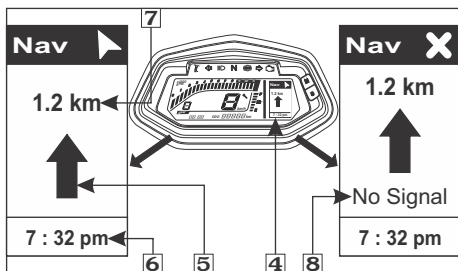

- (4) Navigation mode (5) Direction (6) ETA  
 (7) Distance for next move (8) No signal



### NOTE

At any point, if Navigation system loses signal, then it displays "No Signal" (8) on meter console when vehicle is in navigation mode.



### WARNING

Navigation system assists you to reach your destination, don't be distracted while driving. Drive safely and always obey traffic rules.

### Autopairing:

Your vehicle is equipped with autopairing feature by which if you turn "OFF" vehicle's ignition switch after successful pairing with hero navigation application, it will reconnect automatically once ignition switch is turned "ON".



### NOTE

Always keep your smartphone close to your vehicle during the course of pairing, autopairing and navigation.

### Incoming call alert:

If your smartphone is paired with the meterconsole of your vehicle via bluetooth (page 25), then you will get all the incoming calls alerts on the meter console. It will display the name of the caller if it is stored in your compatible smartphone. For example: If caller's number is stored in your compatible smartphone by name of Vijay, then your meter console will display Vijay calling (1).

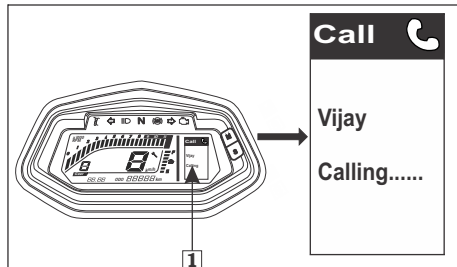

(1) Incoming call alert by name

If the number is not saved in your device by name or your device is an iOS, then it will display "unknown calling" (2).



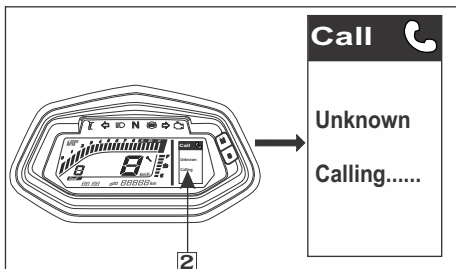

**(2) Incoming call alert by unknown number**

### Missed call alert:

If your smartphone is paired with the meter console of your vehicle via bluetooth (page 25), then you will get all the missed calls alerts (1) on the meter console.

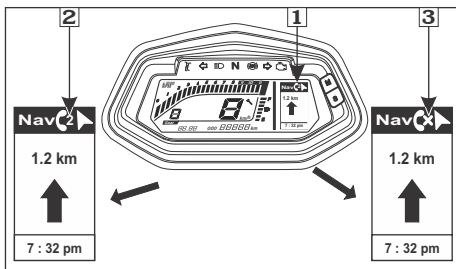

**(1) Missed call alert**  
**(2) Number of missed call (1 to 9)**  
**(3) Number of missed call (more than 9)**

- If number of missed call are less than or equal to 9 then it will display number of missed calls as respective digit (2).
- If number of missed call are more than 9 then it will display as “X” (3).

### Low battery alert:

A symbol of low battery alert (1) appears for few seconds on the meter console if the battery of your paired smartphone is too low.

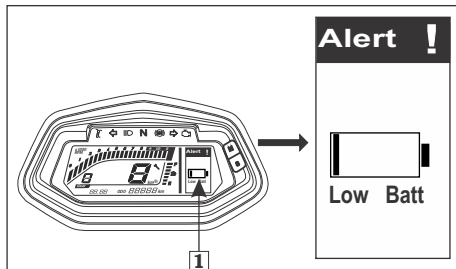

**(1) Low battery alert**

### (e) Steering lock

Steering lock is with the ignition switch, turn the key (1) to “OFF” (⊗) position & turn the handle bar towards left or right & push the key downwards & turn towards “Lock” position. After locking take out the key.



(1) Ignition key

#### (f) Rider footrest

The rubbers (1) of the rider footrest (2) (both side) are detachable and can be detached for “OFF-ROAD” riding only (refer off-road safety guide line (page 11)).

While installing the rider footrest rubbers, the projections (3) of the rider footrest rubbers must be attached to the rider footrest properly.

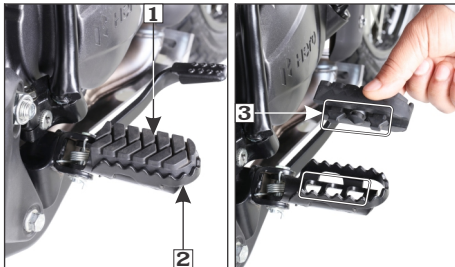

(1) Rubbers  
(3) Projections



(2) Rider footrest

## HANDLEBAR SWITCHES CONTROL

### Left handlebar controls

#### 1. Headlamp dimmer switch/Pass switch

The headlamp operates only when the engine is running.

Press the switch (1) upwards for high beam “” downwards for low beam “”.

Press the pass switch to “PASS” position to operate the pass lamp.

#### 2. Turn signal lamp switch (← →)

Shift the turn signal switch (2) sideways for right/left indications and leave it to come back to its normal position on its own.

**IMPORTANT:** To switch “OFF” the turn signal after completing the turn, gently push the switch inside.



(1) Headlamp dimmer switch/Pass switch  
(2) Turn signal switch  
(3) Horn switch

### 3. Horn switch (📢)

Press the switch to operate the horn (3).

### 4. Clutch switch

There is a clutch switch (4) provided for the safety of the rider. The vehicle cannot be started by electric starter switch until the clutch lever is operated when the vehicle is engaged in gear.

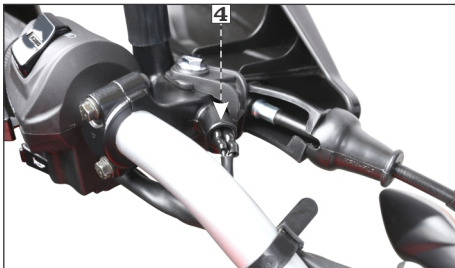

(4) Clutch switch



(1) Electric starter switch

### 2. Engine stop/kill switch

The engine stop/kill switch (2) is provided next to throttle grip. The switch has two positions. In “ON” (⊙) position, engine will operate and in “OFF” (⊗) position, engine will not operate. The prime function of switch is to stop the engine during emergency (Vehicle tip over, throttle cable stuck etc.).



(2) Engine stop/kill switch

### Right handlebar controls

#### 1. Electric starter switch (🔋)

Ensure starter switch (1) is operated when the vehicle transmission is in neutral. If the vehicle is engaged in gear, press the clutch lever before operating the starter switch. Release starter switch after the engine has started.

#### ! CAUTION

*Never hold electric starter switch continuously more than 5 seconds as continuous cranking of engine will discharge the battery.*

The switch should normally remain in “ON” (O) position. During emergency, put the switch to “OFF” (X) position.

**! WARNING**

*While riding the vehicle in normal condition, do not switch off the “Engine stop/kill switch” to avoid any damage (Wheel locking leading to accident, part damage, battery discharge etc.).*

### ABS INDICATOR

The ABS indicator (1) on speedometer come “ON” for approx 1.8 seconds when the ignition switch is turned “ON” (O) & then keeps blinking until the vehicle attains a speed of 5 km/h.

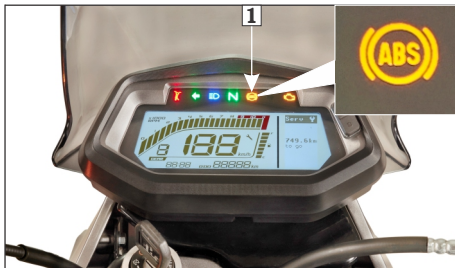

**(1) ABS indicator**

When the system functions normally indicator goes “OFF” (ABS) once vehicle speed exceeds 5 km/h.

At any point if ABS indicator remains “ON” then ABS is not working, but the brakes still work normally. Reduce your vehicle speed and visit your Authorised Hero MotoCorp workshop.

### SIDE STAND INDICATOR/SWITCH

For the safety of the customer a side stand indicator (1) is provided.

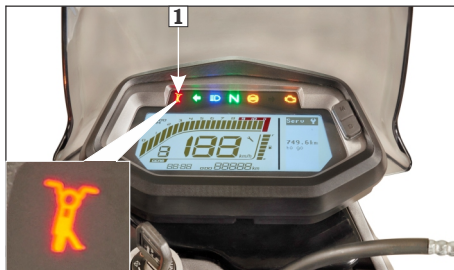

**(1) Side stand indicator**

A side stand switch (2) is provided in the side stand, when the side stand is down (Ignition switch “ON”), the switch enables the side stand indicator lamp to glow on the speedometer panel.

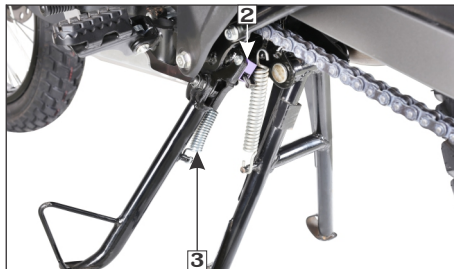

**(2) Side stand switch (3) Side stand spring**

- Check the side stand for proper function and the spring (3) for damage or loss of tension and the side stand assembly for free movement.
- Check whether the side stand indicator (1) glows when the side stand is down.
- While the side stand is up, the side stand indicator (1) should not glow.
- If the side stand indicator (1) does not operate as described in above steps, please visit your Authorised Hero MotoCorp workshop.

### ! CAUTION

*Ensure that adequate care should be taken while cleaning the side stand switch.*

**Your vehicle is equipped with “Side stand engine kill” feature for safety purpose.**

This feature has following functions:

- It prevents starting the engine when transmission is in gear (irrespective of clutch lever operation) and side stand is down.
- It stops the running engine when transmission is in gear (irrespective of clutch lever operation) and side stand is moved down.

### ! WARNING

*“Side stand engine kill” system is not affected by clutch lever operation.*

To inspect the functionality of this feature, park the vehicle on its main stand and check all the conditions described in the inspection flow diagram:

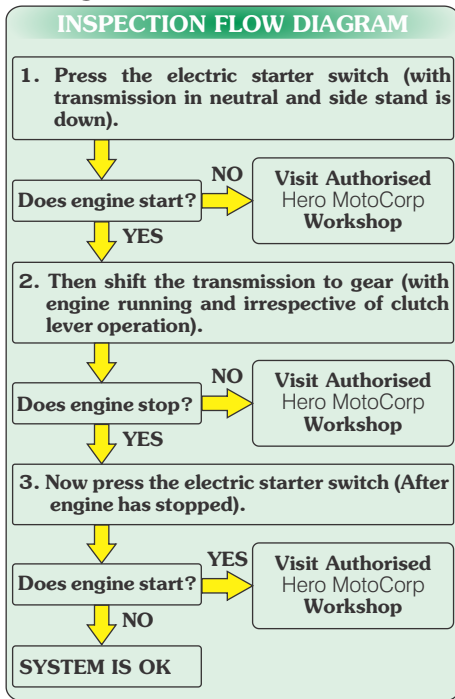

If your vehicle doesn't operate as described in above flow diagram, please visit your Authorised Hero MotoCorp workshop.

**! WARNING**

**Regularly inspect the functionality of "Side stand engine kill" feature and in case of any malfunction visit Authorised Hero MotoCorp workshop.**

### FUEL TANK

Fuel tank capacity is 13.0 litres (Minimum fuel to be maintained above one segment blinking of fuel level indicator).



**(3) Fuel tank cap**



**(1) Key hole cover**

**(2) Ignition key**

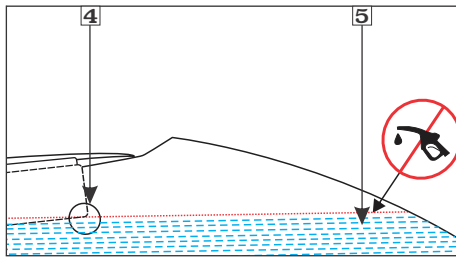

**(4) Filler neck**

**(5) Fuel**

- To unlock fuel tank cap, lift the key hole cover (1), insert key (2) turn it clockwise and lift open the cap (3).
- Do not overfill the tank. There should be no fuel in filler neck (4). Fill the tank with fuel (5) as shown.
- To lock fuel tank cap, close the cap back on the opening and press gently. The key springs back to the normal position and cap gets locked.

- Remove the key and put back the keyhole cover.

**! CAUTION**

**Do not park the vehicle under direct sunlight as it causes evaporation of petrol due to heat and deterioration of paint gloss due to ultra violet rays.**

**! WARNING**

*Petrol is extremely flammable and is explosive under certain conditions. Refill in a well ventilated area with the engine stopped. Do not smoke or allow flames or sparks in the area where the vehicle is refilled or where petrol is stored.*

## SEAT LOCK

**Location:** On the left side of the rear cowl, below the rear grip.

**Operation:** Insert the ignition key (1) and turn is clock wise to unlock the seat. To install, engage the hook on the underside of the seat with the frame and slide the seat to the front until the lock clicks.

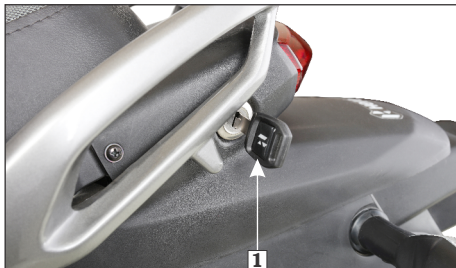

**(1) Seat lock**

## HELMET HOLDER

The helmet holder is located below the seat. Remove the seat. Hang the helmet on the helmet holder hook (1) using wire helmet set (2) supplied with the vehicle. Install the seat (3) and lock it securely.

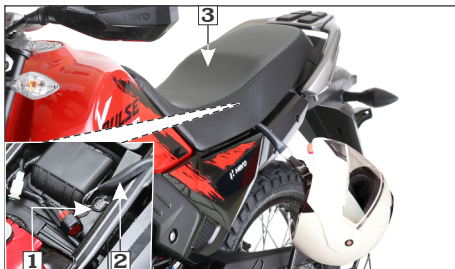

**(1) Helmet holder hook (2) Wire helmet set  
(3) Seat**

**! WARNING**

- *Riding with a helmet attached to the holder can interfere with the rear wheel of suspension and could cause a crash in which you can be seriously hurt or killed.*
- *Use the helmet holder only while parked. Do not ride with a helmet secured by the holder.*

## USB CHARGER

A USB charger (1) with a cap (2) located inside the USB device compartment (3) is provided in your vehicle under the seat to charge your mobile phone safely while riding.

To connect a mobile phone charger, first remove the cap from the USB charger and then plug in the charger cable to it.

Use of non-standard USB cable may cause damage to the mobile phones.

Hero MotoCorp will not be responsible for damages caused due to use of non standard USB cable.

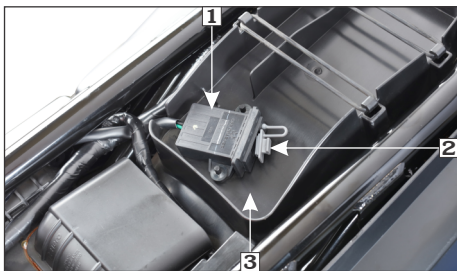

- (1) USB charger (2) Cap  
(3) USB device compartment

### ! CAUTION

- *Always place the device in a soft clean cloth/towel to avoid any damage due to road shocks while riding.*
- *This port is for charging compatible USB devices.*
- *Multiple charging of USB devices have to be avoided, simultaneous charging may lead to slow or no charging.*
- *Do not leave the USB device and USB cable in the USB device compartment when the vehicle is parked.*
- *Charge your device only when the engine is operational/while riding. Charging the USB device when the engine is "OFF" would lead to early discharge of battery.*



### NOTE

- *Do not apply any soap solution, oil or grease inside the USB charger.*
- *Any personal belongings have to be removed before water washing to avoid damage.*

- *Always keep the USB port cap closed after use to prevent dust or water entry during rains/water wash.*
- *Do not direct water jet towards the port even with cap closed to avoid any short circuit. Always dry the area using a dry cloth or moisture free compressed air before use.*

### PRE - RIDE INSPECTION

You should conduct pre ride inspection before riding the vehicle to enhance riding comfort and safety.

Clean your vehicle regularly. It protects the surface finish. Avoid cleaning with products that are not specifically designed for vehicle surfaces.

Inspect your vehicle every day before you start the engine. The items listed here will only take a few minutes, and in the long run they can save time, expense, and possibly your life. Please follow the tips as given below:

- **Engine oil level**—Check and top up engine oil if required (**page 49**). Check for leaks.
- **Programmed FI malfunction indicator lamp (MIL)**—When the ignition switch is turned "ON" the programmed FI malfunction indicator lamp (MIL) glows continuously and then should go "OFF" once the engine is started.
- **Fuel level**—Ensure sufficient fuel is available in your fuel tank for journey. Fuel level segment should be above one segment blinking (**page 22**). Check for leaks
- **Front brake**—Check for correct brake fluid level in master cylinder /reservoir (**page 60**).



- **ABS indicator**–Check ABS indicator for proper functioning of ABS (**page 32**).
- **Rear brake**–Check for correct brake fluid level in the reservoir (**page 61**).
- **Tyres**–Check condition and pressure (**page 66**).
- **Clutch**–Check for smooth operation. Adjust free play if necessary (**page 55**).
- **Drive chain**–Check condition and slackness (**page 56**). Lubricate if necessary.
- **Throttle**–Check for smooth opening and closing in all steering positions (**page 56**).
- **Lamps & Horn**–Check that headlamp, position lamps, tail/stop lamp, turn signal lamps, indicators and horn function properly.
- **Rear view mirror**–Ensure that the rear view mirror gives a good rear view when you are sitting on the vehicle.
- **Engine stop/kill switch**–Check for proper functionality (**page 31**).
- **Fitting & Fasteners**–Check & tighten if necessary.
- **Steering**–Check for smooth action and for easy maneuverability.
- **Side stand**–Check for proper functionality (**page 32**).

Your vehicle's exhaust contains poisonous carbon monoxide gas. High levels of carbon monoxide can collect rapidly in enclosed areas such as garage. Do not run the engine with the garage door closed.

### ! CAUTION

- *If electric starter switch is pressed continuously and engine does not start, cranking of engine will stop after 5 secs. After that rider again needs to press the electric starter switch.*
- *This vehicle is equipped with a side stand engine kill feature (page 32).*

### Preparation

Before starting insert the key and follow the below mentioned procedure :

- Turn the ignition switch (1) "ON" position.
- Confirm that the programmed FI malfunction indicator lamp (MIL) (2) glows continuously and then should go "OFF" once the engine is started.

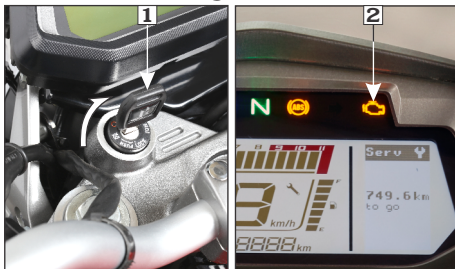

- (1) Ignition switch
- (2) Malfunction indicator lamp (MIL)

### STARTING THE ENGINE

Always follow the proper starting procedure described below :

- To protect the catalytic converter in your vehicle's exhaust system, avoid extended idling and the use of leaded petrol.



## NOTE

*If MIL remains "ON" even if the vehicle is started, there is an abnormality in the programmed FI system. It is recommended to reduce the speed and drive to the Authorised Hero MotoCorp workshop for check-up.*

- Find neutral position & check neutral (N) indicator (3) on instrument console with ignition "ON".
- Make sure that the engine stop switch/kill switch (4) is at "ON" (O) position.

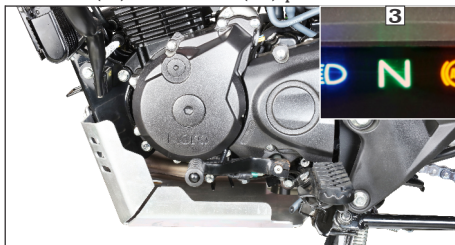

(3) Neutral indicator



(4) Engine stop/kill switch

- **Electric start** : Press the electric starter switch with fully closed throttle.
- **Kick start** : Depress the kick starter until resistance is felt. Then let the kick starter return to the top of its stroke. Kick from the top of the stroke through to the bottom with a rapid, continuous motion.

## Starting procedure

At any ambient temperature, Press the starter switch with the throttle completely closed.



## NOTE

- *This vehicle has a fuel-injected engine with an idle air control valve (IACV).*
- *The engine will not start if the throttle is open because the Electronic control unit (ECU) cuts-off the fuel supply.*

## Flooded engine

If the engine fails to start after repeated attempts, it may be flooded with excess fuel.

- Open the throttle fully.
- Press the starter switch for 5 seconds.
- Follow the normal starting procedure.
- If the engine starts with unstable idle, open the throttle slightly.
- If the engine does not start wait for 10 seconds, then follow first 3 step again.

## Ignition cut off

Your vehicle is designed to automatically stop the engine & fuel pump, if vehicle falls down.

**(Bank angle sensor cuts off the ignition).**



## NOTE

- If the vehicle has fallen down, before restarting the engine you must turn the ignition switch to "OFF" (X) position and then back to "ON" (O) position.*

## Running in

Help assure your vehicle's future reliability and performance by paying extra attention to how you ride during the first 500 km.

During this period, avoid full-throttle starts and rapid acceleration.



### NOTE

- To start the engine if any gear is engaged, press the clutch lever and press the starter switch.
- Do not open the throttle during starting the vehicle.



### WARNING

Never run the engine in a closed area, the exhaust contains poisonous gases.

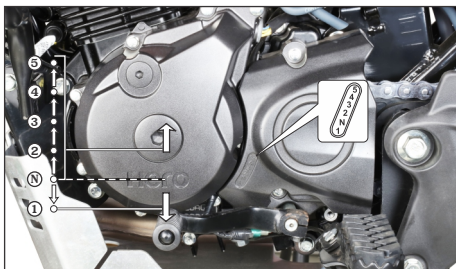

### CAUTION

Do not shift gears without operation of clutch and without closing the throttle otherwise this would lead to damage of gears.

## RIDING

- After the engine has been warmed up, the vehicle is ready for riding.
- While the engine is idling, press the clutch lever and depress the gearshift pedal downwards using the toe to shift into 1<sup>st</sup> gear.
- Slowly release the clutch lever and at the same time, gradually increase engine speed by opening the throttle. Coordination of the throttle and clutch lever will assure a smooth positive start.
- When the vehicle attains a moderate speed, close the throttle, press the clutch lever and shift to 2<sup>nd</sup> gear by placing the toe on the underside of gear pedal and lift upwards.
- This sequence is repeated progressively to shift to 3<sup>rd</sup>, 4<sup>th</sup> and 5<sup>th</sup> gear.

## BRAKING

### Anti-lock braking system (ABS)

This model is equipped with Anti-lock braking system (ABS). ABS enhances active safety by helping to prevent the wheels from locking under braking.

ABS is designed to meet two essential requirements during every brake application:

- To help provide vehicle stability.
- To help maintain steering control and manoeuvrability—on road surfaces.

**The ABS system is self-regulating and always active once vehicle speed exceeds 5 km/h.**

- The ABS computer acts on the basis of the comparative speeds of the front wheel. The use of non-approved tyres can affect the

speed of the wheels and supply incorrect information to the ABS computer.

The system has a wheel speed sensor (1), hydraulic electronic control unit (HECU) (2), and an ABS indicator lamp (3) on meter console.

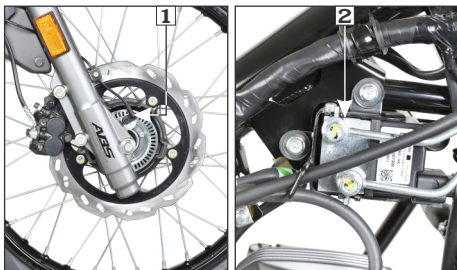

(1) Wheel speed sensor

(2) Hydraulic electronic control unit (HECU)

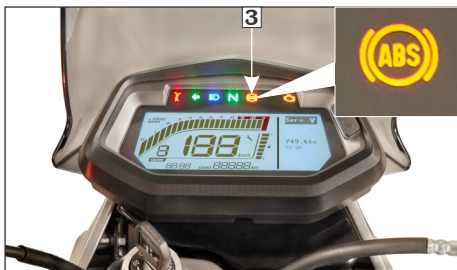

(3) ABS indicator

Whenever you ride your vehicle, **Wheel speed sensor** monitors the speed of the wheel and sends the input to **Hydraulic Electronic control unit (HECU)**. Then **HECU** monitors your bike and takes control when vehicle speed exceeds 5 km/h.

Now whenever you will apply front brake, ABS will come into picture and based on the input from wheel speed sensor, HECU will modulate the pressure at front caliper thus avoiding wheel to lock and in turn resulting safe stop of the vehicle.

### Do's and Dont's

#### Do's

- Check your brake pads and be sure you have clean brake fluid. ABS systems can also fail due to worn brake pads or air or dirt in brake fluid.
- Use the recommended brake fluid.
- If brake gets wet, apply the brake while riding at low speed to help them dry.
- It is recommended that ABS should be serviced at Authorised Hero MotoCorp workshop.
- Read your owner's manual for additional riding instructions.
- Carefully remove the wheel during the puncture/tyre replacement to prevent the Sensing ring damage/bend.
- Use only the recommended make, type, size of tyre and maintain specified tyre pressure (page 66).
- Keep checking speedometer. In case of ABS malfunction, speed display may go to zero.

- Always maintain sufficient distance from the objects/vehicles ahead, for proper braking and to match riding speed.
- On certain surfaces, such as rough road or gravel road, brake lever may have hard/pulsating feel. Apply full braking on the lever even on the hard or pulsating feel of the lever to get the optimum performance.
- In case of ABS malfunction, the brake system will work as conventional (Non-ABS) brake. Rider is recommended not to apply hard brake to prevent wheel lock and visit Authorised Hero MotoCorp workshop.

### Don't's

- Don't panic by mechanical noises or slight lever pulses while applying the brake (whenever ABS actuates) in vehicle. These conditions are normal and indicates that ABS is working.
- Don't apply the hard braking in wet or rainy conditions and while taking a turn.
- Do not adjust the wheel speed sensor air gap yourself.
- Do not attempt to correct the encoder teeth by bending manually or by using any other mode. Do not use a different encoder teeth
- Do not insert any metallic part near wheel speed sensor.
- Don't try to service HECU or open to separate the parts.
- Don't use the non-genuine spares like pads, discs, tyres etc.



### NOTE

- **ABS may get activated without brake application while riding on uneven road surfaces (sharp drop or rise on the road level). This is normal functioning of ABS and won't be having any impact on performance.**
- **ABS may not work if the battery is discharged.**
- **ABS operation is also affected by road conditions, vehicle handling and brake operation. It is the rider's responsibility to ride at reasonable speed and to leave a margin of safety.**
- **ABS consists of an electric motor, from which sound can be heard.**

### PARKING

After stopping the vehicle, shift the transmission to neutral, turn the ignition switch "OFF" (⊗), park the vehicle on main stand, lock the steering and remove the key.



### CAUTION

- **Park the vehicle on firm level ground to prevent overturning.**
- **While parking on side stand engage the first gear.**

### TOOL KIT

The tool kit (1) is located under the seat. Some emergency repairs, minor adjustment and parts replacement can be performed with the tools contained in the kit.

Kit consists of following tool:

- Tool bag-1 No.
- + , -Driver No.2-1 No.
- Grip-1 No.
- Box wrench P16 x 14-1 No.
- Handle pin spanner- 1 No.
- Wire helmet set-1 No.
- Pin spanner-1 No.
- No.3 cross point screw driver-1 No.



**(1) Tool kit**

### FIRST AID KIT

The first aid kit (1) is located below the seat. For some emergency first aid can be performed by medicine contained in the kit.

Kit contains the following items :

- Antiseptic cream-1 No.
- Sterilised dressing-1 No.
- Water proof plaster- 1 No.
- Elastic bandage-1 No.
- Gauze (Rolled bandage)-1 No.
- Sterilised elastic plaster-1 No.
- First aid bag- 1 No.

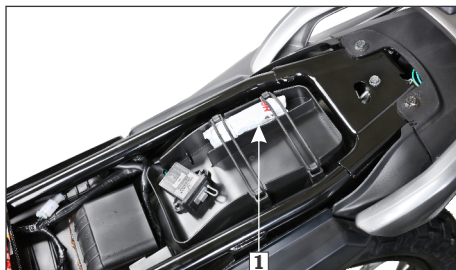

**(1) First aid kit**

### CLEANING AND WASHING OF VEHICLE

Follow the below mentioned steps for washing the vehicle.

- Wet the vehicle with light water spray. Avoid directing high pressure water spray to meter console, muffler outlets, electrical parts and oil cooler.
- Clean the headlamp lens and other plastic parts using a cloth or sponge dampened with a solution of mild detergent and water.
- After cleaning spray water thoroughly.
- Dry the vehicle by wiping with dry soft cloth.



#### NOTE

*Our authorised dealership take all above mentioned precautions like recommended detergents and usage of muffler caps/plugs and oil cooler cover during wash to ensure quality wash.*



#### WARNING

*Avoid direct high pressure water spray on any electrical, electronic components and oil cooler.*

## MAINTENANCE

### The importance of maintenance

A well-maintained vehicle is essential for safe economical and trouble-free riding. It will also help reduce pollution.

To help you, take proper care of your vehicle, the following pages include a maintenance schedule and a maintenance record for regular scheduled maintenance.

These instructions are based on the assumption that the vehicle will be used exclusively for its designed purpose. Sustained high speed operation or operation in unusually wet or dusty conditions will require more frequent service than specified in the maintenance schedule. Consult your Authorised Hero MotoCorp dealer for recommendation applicable to your individual needs and use. If your vehicle overturns or is involved in a crash, be sure that you visit your Authorised Hero MotoCorp workshop for detailed inspections.

#### WARNING

- ***Improperly maintaining this vehicle or failing to correct a problem before you ride can cause a crash in which you can be seriously hurt or killed.***
- ***Always follow the inspection and maintenance recommendations and schedules in this owner's manual.***

### Maintenance safety

This section includes instructions on some important maintenance tasks. You can perform some of these tasks with the tools provided (if you have basic mechanical skills).

Other tasks that are more difficult and require special tools are best performed by professionals. It is recommended that wheel removal should normally be handled by a Hero MotoCorp authorised workshop.

You will come across some of the most important safety precautions in the following pages of this manual.

However, we cannot warn you of every conceivable hazard that can arise in performing maintenance. Only you can decide whether or not you should perform a given task.

#### WARNING

- ***Failure to follow maintenance instructions and precautions properly can seriously injure you.***
- ***Always follow the procedures and precautions in this owner's manual.***

## SAFETY PRECAUTIONS

- Make sure the engine is “OFF” before you begin any maintenance or repair. This will help to eliminate several potential hazards:
  - **Carbon monoxide poisoning from engine exhaust.**  
Be sure there is adequate ventilation whenever you operate the engine.
  - **Burns from hot parts.**  
Let the engine and exhaust system cool before touching.
  - **Injury from moving parts.**  
Do not run the engine unless instructed to do so.
- Read the instruction before you begin and make sure you have the tools and skills required.
- To help prevent the vehicle from falling over, park it on a firm, level surface on the main stand.
- To reduce the possibility of a fire or explosion, be careful when working around petrol or batteries. Use only nonflammable solvent, not petrol, to clean parts. Keep cigarettes, sparks and flames away from the battery and all fuel-related parts.

Remember that your Authorised Hero MotoCorp workshop knows your vehicle best and is fully equipped to maintain and repair it.

To ensure best quality and reliability, it is recommended to use Hero MotoCorp genuine parts for repair and replacement.



## MAINTENANCE SCHEDULE

Perform the pre-ride inspection (**page 36**) at each scheduled maintenance period.

**I: INSPECT C: CLEAN R: REPLACE A: ADJUST L: LUBRICATE O: OIL CHANGE  
T: TOP UP E: EMISSION CHECK**

The following maintenance schedule specifies all maintenance required to keep your vehicle in peak operating condition. Maintenance work should be performed in accordance with standards and specifications of Hero MotoCorp by properly trained and equipped technicians. Your Authorised Hero MotoCorp workshop meets all of these requirements.

Ensure that each paid service is availed within **90** days or **3000** km from the date of previous service, whichever is earlier.

↘ To be serviced by your Authorised Hero MotoCorp workshop unless the owner has the relevant tools, technical information and is technically qualified.

✘ In the interest of safety, we recommend that these jobs are carried out only by your Authorised Hero MotoCorp workshop.

**Note- 1** : At higher odometer readings, repeat the frequency interval established here.

**Note-2** : Service more frequently if the vehicle is ridden in unusually wet or dusty areas.

**Note-3** : Replace engine oil once in every **6000** km. Top up if the oil level is at or near the lower level mark.

**Note-4** : Visit Authorised Hero MotoCorp workshop for inspection, cleaning, lubrication and adjustment of drive chain at every **700** km.

**Note-5** : Replace brake fluid once in every two years or **30000** km, whichever is earlier.

**Note-6** : Inspect & maintain specified torque.

**Note-7** : Inspect the wheel bearings free play, replace if necessary.

**Note-8** : Replace front fork oil once in a every **2** years or **30000** km, whichever is earlier.

**Note-9** : Inspect rear suspension mounting bushes play, replace rear shock absorber if necessary.

**Note- 10**: Check CO emission at idle.

**Note- 11**: Inspect the canister hoses for deterioration, damage or loose connections and canister for cracks or other damages.

**Note**: Always wipe the water from the vehicle after washing. Use clean soft cloth or pressurized air for completely drying the water.













or Scan QR code

## MAINTENANCE SCHEDULE

Dear Customer,

We would strongly recommend the following schedule, to keep your vehicle in perfect running condition and healthy environment. Vehicle subjected to severe use or ridden in dusty area will require more frequent servicing.

ITEMS	WHICHEVER COMES FIRST	DURING FREE SERVICE PERIOD					AFTER FREE SERVICE ONCE IN EVERY					
	SERVICE	1 <sup>st</sup>	2 <sup>nd</sup>	3 <sup>rd</sup>	4 <sup>th</sup>	5 <sup>th</sup>						
	DAYS	1st 60	Next 100	Next 100	Next 100	Next 100						
	KM Note-1	500-750	3000-3500	6000-6500	9000-9500	12000-12500	3000	6000	9000	12000	15000	
Fuel Line		I	I	I	I	I	I					
Throttle Operation		I, A	I, A	I, A	I, A	I, A	I, A					
Air Cleaner Element	<b>Note-2</b>	C	C	C	C	R	C				R	
Spark Plug		I, C, A	I, C, A	I, C, A	I, C, A	R	I, C, A				R	
Valve Clearance		I, A	I, A	I, A	I, A	I, A	I, A					
Engine Oil	<b>Note-3</b>	O	I, T	O	I, T	O	I, T	O				
Engine Oil Strainer Screen		C		C		C	C	C				
Engine Oil Centrifugal Filter		C		C		C	C	C				
Engine Oil Cooler & Hoses		I	I	I	I	I	I					
Electric Starter		I	I	I	I	I	I					
Oil Circulation		I	I	I	I	I	I					
Drive Chain	<b>Note-4</b>	I,C,L,A at every 700 km					I,C,L,A at every 700 km					
Drive Chain Slider			I	I	I	I	I					

ITEMS		WHICHEVER COMES FIRST	DURING FREE SERVICE PERIOD					AFTER FREE SERVICE ONCE IN EVERY					
			SERVICE	1 <sup>st</sup>	2 <sup>nd</sup>	3 <sup>rd</sup>	4 <sup>th</sup>						5 <sup>th</sup>
		DAYS	1st 60	Next 100	Next 100	Next 100	Next 100	Next 100					
		KM Note-1	500- 750	3000- 3500	6000- 6500	9000- 9500	12000- 12500	3000	6000	9000	12000	15000	
	Battery Voltage		I	I	I	I	I	I					
	Brake Pads Wear		I	I	I	I	I	I					
	Brake Fluid	<b>Note-5</b>	I	I	I	I	I	I					
	Brake System (Brake Pedal)			I, C, L			I, C, L			I, C, L			
	Stop Lamp Switch		I, A	I, A	I, A	I, A	I, A	I, A	I, A				
	Headlamp Focus		I, A	I, A	I, A	I, A	I, A	I, A	I, A				
	Clutch Lever Free Play		I, A	I, A	I, A	I, A	I, A	I, A	I, A				
	Side Stand/ Main Stand (Optional)		L	L	L	L	L	L	L				
	Side Stand Switch		I, C	I, C	I, C	I, C	I, C	I, C	I, C				
	Nut, Bolts & Fasteners	<b>Note-6</b>	I	I	I	I	I	I	I				
	Wheels Bearings	<b>Note-7</b>	I	I	I	I	I	I	I				
	Wheel/Tyres		I	I	I	I	I	I	I				
	Steering Head Bearing		I	I, A	I	I, A	I, L, A	I	I, A		I, L, A		
	Front Suspension/Oil	<b>Note-8</b>	I	I	I	I	I	I	I				
	Rear Suspension	<b>Note-9</b>	I	I	I	I	I	I	I				
	Muffler (Catalytic Converter)	<b>Note-10</b>			I, E		I, E		I, E				
	Evaporative Emission Control System	<b>Note-11</b>	I	I	I	I	I	I	I				

## SPARK PLUG INSPECTION

### Recommended plugs: NGK-CPR 8 EA9

For most riding conditions this spark plug heat range number is satisfactory. However, if the vehicle is going to be operated for extended periods at high speeds or near maximum power in hot climates, the spark plug should be changed to a cold heat range number, consult Authorised Hero MotoCorp workshop on this if required.

- Clean dirt around the spark plug base.
- Disconnect the noise suppressor cap (1) and remove the spark plug (2) with the help of spark plug box wrench provided in the tool bag.



(1) Noise suppressor cap

(2) Spark plug

- Visually inspect the spark plug electrodes for wear. The center electrode should have square edges and the side electrode should not be eroded. Discard the spark plug if there is apparent wear or if the insulator is cracked or chipped.

- Make sure that the spark plug gap is **0.8-0.9 mm** using a wire-type feeler gauge. If adjustment is necessary, bend the side electrode carefully. Make sure the plug washer is in good conditions.

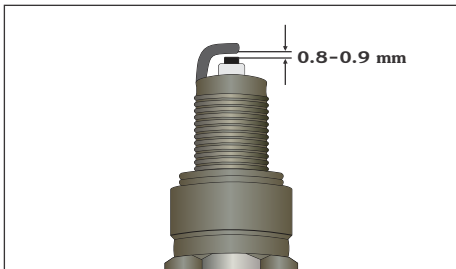

- With the plug washer attached, thread the spark plug in by hand to prevent cross-threading.
- Tighten a new spark plug 1/2 turn after the plug seats, with a spark plug box wrench to compress the washer. If you are reusing a plug, it should only take 1/8-1/4 turn after the plug seats.

### **!** CAUTION

- *Do not remove the spark plug and test for spark on the vehicle by cranking the engine as this could lead to fire or explosion*
- *Never use a spark plug with improper heat range.*
- *Install a dummy spark plug in the cylinder head and test for spark.*
- *Always use resistor type spark plug.*

## ENGINE OIL

Use hero genuine engine oil or recommended grade oil.

**BRAND: Hero 4T plus**

**GRADE: SAE 10W 30 SL Grade**

**(JASO MA2).**

Manufactured by:

- Tide Water Oil Co. (India) Ltd.
- Savita Oil Technologies Limited.
- Bharat Petroleum Corporation Limited.

**OIL CAPACITY : 1360 ml**

**Engine oil level inspection /**

**Top up process**

Check engine oil level each day before operating the vehicle. The oil level dipstick (1) is on the right crankcase cover for measuring oil level. Oil level must be maintained between the upper (2) and lower (3) level marks on the oil level dipstick.

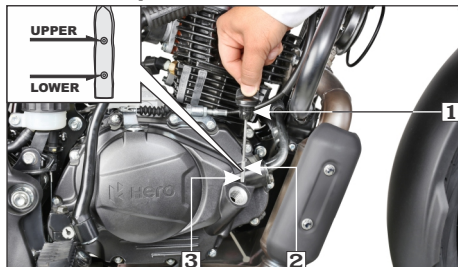

(1) Oil level dipstick (2) Upper level mark  
(3) Lower level mark

- Do top up if oil level reaches towards the lower level mark or every 3000 km whichever is earlier.
- Park the vehicle on its main stand.
- Start the engine & let it idle for 3-5 minutes.
- Slightly loosen the engine oil check bolt (4) and check the engine oil entry into the cylinder head cover.

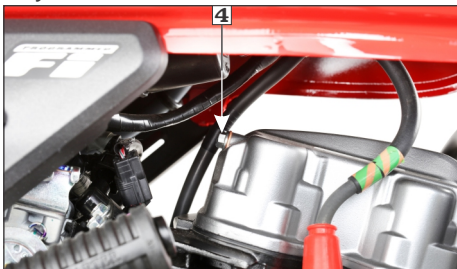

(4) Engine oil check bolt

- After checking the oil circulation, tighten the engine oil check bolt.
- Stop the engine and wait for 2-3 minutes.
- Remove the oil level dipstick, wipe it clean and insert without screwing it in.
- Remove the oil level dipstick and check the oil level.
- If required, add the specified oil up to the upper level mark. Do not overfill.
- Quantity of oil to be filled is 1170 ml (approx.) during oil change (when right crankcase cover is not removed).

- Reinstall the oil level dipstick with new O-ring and check for oil leaks.

### Engine oil replacement/ Oil circulation inspection

- Start the engine, warm it up for several minutes and then turn it off.
- Wait a few minute until the oil settles down.
- Remove the bash plate bolts (1) and bash plate (2).
- To drain the oil, remove the oil level dipstick, drain bolt (3) and sealing washer (4).
- After the oil has completely drained, reinstall the drain bolt (3) with a new sealing washer (4).
- Fill the crankcase through the oil filler hole with 1170 ml (approximately) of recommended grade oil during oil change (when right crankcase cover is not removed).

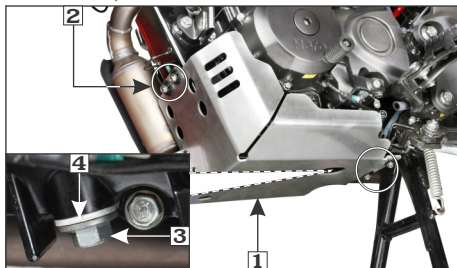

(1) Bash plate bolts  
(3) Drain bolt

(2) Bash plate  
(4) Sealing washer

- Reinstall the oil level dipstick with a new O-ring.
- Install the bash plate.
- Start the engine and allow it to idle for few minutes.
- Stop the engine and let the engine oil settle down.
- Recheck the oil level.
- Make sure that oil level is at the “UPPER” level mark of the oil level dipstick with the vehicle in an upright position and that there are no oil leaks.

### ! CAUTION

- **Running the engine with insufficient oil can cause serious engine damage.**
- **Running the engine with excessive oil can cause spark plug fouling & loss in performance.**
- **Engine oil is a major factor affecting the performance and service life of the engine. Non-detergent, vegetable or castor based racing oils are not recommended.**

### OIL FILTER SCREEN & CENTRIFUGAL FILTER CLEANING

- Drain the engine oil thoroughly (**page 50**).
- Remove the kick starter pedal (1).
- Disconnect the clutch cable (2) from right crankcase cover (3).
- Remove the swingarm nut (4), rider footrest bracket bolt (5), rider footrest bracket cover bolt (6), footrest bracket assembly (7) and right crankcase cover.
- Remove the oil cooler hoses (8) by removing its bolt (9).

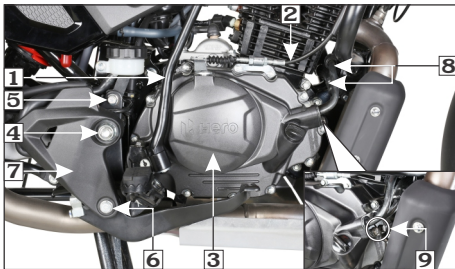

- (1) Kick start pedal (2) Clutch cable
- (3) Right crankcase cover (4) Swingarm nut
- (5) Rider footrest bracket bolt
- (6) Rider footrest bracket cover bolt
- (7) Footrest bracket assembly
- (8) Oil cooler hoses (9) Oil cooler hoses bolt

- Remove the dowel pins (10) and gasket (11).

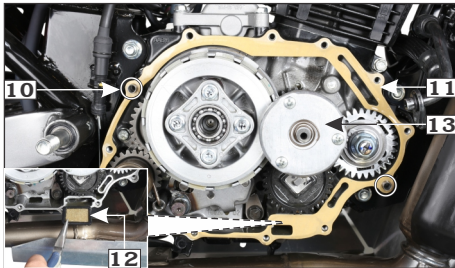

- (10) Dowel pins (11) Gasket
- (12) Oil filter screen
- (13) Centrifugal filter cover

- Remove the oil filter screen (12) and wash it in clean non flammable or high flash point solvent (kerosene).
- Reinstall the filter screen with the tapered end facing in.
- Remove centrifugal filter cover with gasket (13) & clean the centrifugal filter (14) with non flammable or high flash point solvent (kerosene).



(14) Centrifugal filter

- Reinstall the centrifugal filter cover with new gasket.
- Install the new dowel pins & gasket, right crankcase cover and connect the clutch cable.
- Install the oil cooler hoses by tightening its bolt.
- Install the footrest bracket assembly.
- Install and tighten the rider footrest bracket cover bolt, rider footrest bracket bolt and swingarm nut.

**Swingarm nut torque: 5.4 kgf-m**

- Install the kick starter pedal.
- Fill the crankcase with clean engine oil as per specification (**page 45**).



### NOTE

- **Clean filters as specified in the maintenance schedule.**
- **Ensure to replace gasket & dowel pin with new one once removed**



### CAUTION

**Ensure that adequate care should be taken while removing the oil cooler hoses to avoid any damage or leakage.**

## ENGINE OIL COOLER

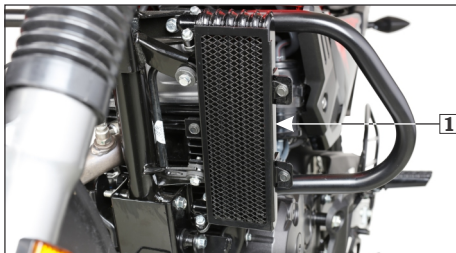

(1) Engine oil cooler



### CAUTION

- **No hard objects to be used for cleaning the engine oil cooler (1), otherwise the fins will get damaged.**
- **No high pressure washing of the oil cooler as it may damaged the fins, any physical contact with fins is to be avoided.**

## AIR CLEANER

### Air cleaner element inspection

Refer to the safety precautions (**page 44**).

The air cleaner element is of dry paper pleated type, it should be serviced at regular intervals (**page 45**). Service more frequently when riding in unusually wet or dusty areas.

- Remove the seat (**page 35**).
- Remove the right side cover screws (1), side cover (2) by releasing the lug from the grommet (3) and slide the cover towards the rear to release tab from the slot (4).

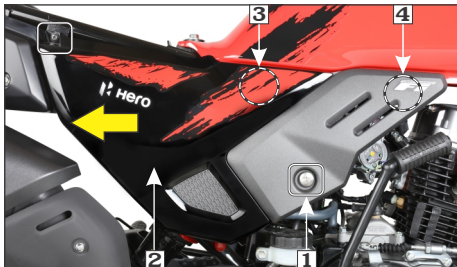

(1) Right side cover screws      (2) Side cover  
(3) Lug/Grommet                      (4) Tab/Slot

- Remove the air cleaner cover screws (5) and the cover (6).
- Remove the air cleaner element (7) from air cleaner housing (8).



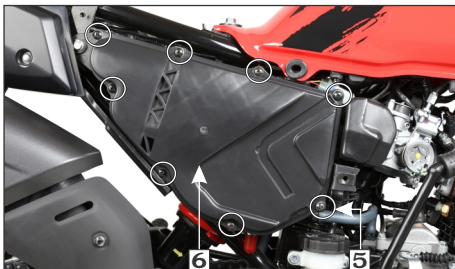

(5) Air cleaner cover screws

(6) Air cleaner cover

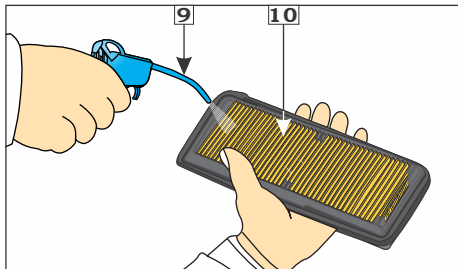

(9) Air nozzle

(10) Housing side

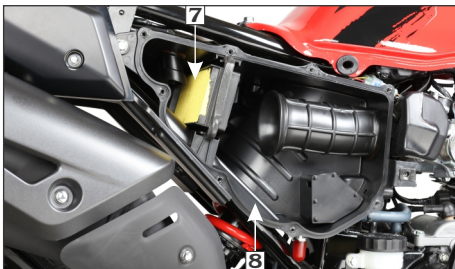

(7) Air cleaner element (8) Air cleaner housing

**! CAUTION**

- Never wash the air cleaner element. Only blow air in the air cleaner element for cleaning dust, as explained. Replace air cleaner element once in every 12000 km.
- Replace it earlier if it becomes very dirty, damaged on surface or on the sealing area.

- Air cleaner element cleaning
  - Clean the element by tapping it gently to loosen dust.
  - Blow away the remaining dust by forcing compressed moisture-free air using an air nozzle (9) from the housing side (10) of the air cleaner.
  - Replace the air cleaner element if it is excessively dirty, torn or damaged.

- Install the air cleaner element.
- Install the air cleaner cover.
- Install the right side cover.
- Install the seat (page 35).

**Air cleaner drain tube cleaning**

Remove the drain tube (1) and drain the deposit into a container.

Follow the above process more frequently when riding in rain or at full throttle.

**NOTE**

*Always ensure to reinstall the drain tube after draining the deposit.*



(1) Drain tube

## VALVE CLEARANCE ADJUSTMENT

Excessive valve clearance will cause noise, and little or no clearance will prevent the valve from closing and cause valve damage and power loss. Check valve clearance at the specified intervals (**page 45**).



### NOTE

*The checking or adjustment of valve clearance should be performed while the engine is cold. The clearance will change as the engine temperature rises.*

- Remove the fuel tank.
- Remove the crankshaft hole cap (1) and timing hole cap (2).
- Remove the cylinder head cover.
- Rotate the flywheel anticlockwise until the “T” mark (3) on the flywheel coincides with the index mark (4) on the left crankcase cover. In this position the piston will either be on the compression or exhaust stroke.

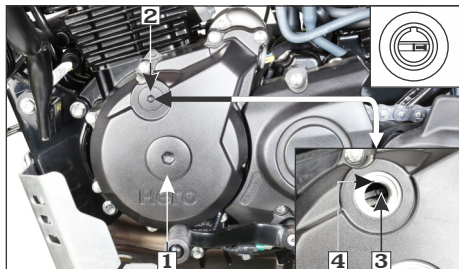

(1) Crankshaft hole cap  
(3) “T” mark

(2) Timing hole cap  
(4) Index mark

The adjustment must be made when the piston is at top dead center and both the inlet and exhaust valves are closed.

This condition can be determined by moving the rocker arms. If they are free, it is an indication that the valves are closed and the piston is in compression stroke. If they are tight, the valves are open, rotate the flywheel 360° anticlockwise and realign the “T” mark with the index mark.

- Check the clearance by inserting the feeler gauge (5) between the adjusting screw (6) and valve stem (7).

### Standard clearance (cold condition)

**Intake: 0.07 mm +0.01 / -0.02**

**Exhaust: 0.09 mm +0.01 / -0.02**

- If adjustment is required, adjust by loosening the lock nut (8) and turning the adjusting screw until there is a slight drag on the feeler gauge.

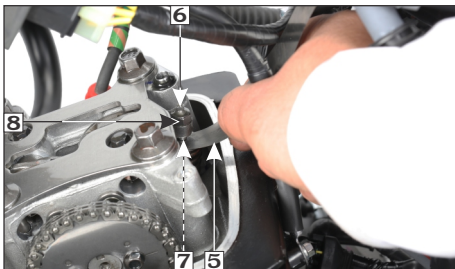

(5) Feeler gauge (6) Adjusting screw  
(7) Valve stem (8) Lock nut



- After tightening the lock nut, check the clearance again.
- Installation is in the reverse order of removal.



#### NOTE

*Before inserting the feeler gauge, smear a bit of engine oil on the feeler gauge to avoid damage to the feeler gauge.*

## CLUTCH LEVER FREE PLAY

### Adjustment

Clutch adjustment may be required if the vehicle stalls when shifting into gear or tends to creep or if the clutch slips, causing acceleration to lag behind engine speed.

Normal clutch lever free play (1) is 10–20 mm at the lever (2).



(1) Free play: 10–20 mm (2) Clutch lever

- To adjust the free play, loosen the lock nut (3). Turn the adjusting nut (4) to obtain the specified free play. Tighten the lock nut and check the adjustment.
- Start the engine, press the clutch lever and shift into gear. Make sure the engine does not stall, and the vehicle does not creep. Gradually release the clutch lever and open the throttle. The vehicle should start smoothly and accelerate.

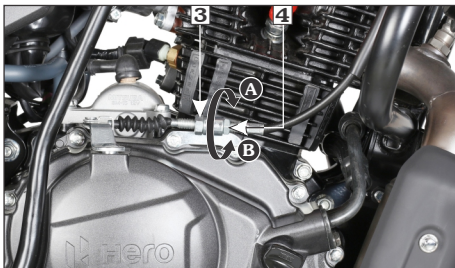

(3) Lock nut (4) Clutch cable adjusting nut  
(A) Decrease free play (B) Increase free play



### NOTE

*If proper adjustment cannot be obtained or the clutch does not work correctly, visit your **Authorised Hero MotoCorp workshop.***

### Other checks

- Check the clutch cable for kinks or signs of wear that could cause sticking or failure.
- Check for clutch cable model. Use genuine clutch cables.
- Check for clutch cable routing.

### THROTTLE OPERATION

#### Cable inspection

Check for smooth rotation of the throttle grip from the fully open to the fully closed position. Check at full left and full right steering positions. Inspect the condition of the throttle cable from the throttle grip down to the throttle body. If the cable is kinked, chafed or improperly routed, it should be replaced or

rerouted. Standard throttle grip free play (1) is approximately 2–6 mm of grip rotation.



(1) Free play: 2–6 mm

#### Free play adjustment

To adjust the free play, slide the boot (2), then loosen the lock nut (4). Turn the adjuster (3) to adjust free play. After adjustment, tighten the lock nut and slide the boot on the adjuster and locknut securely.

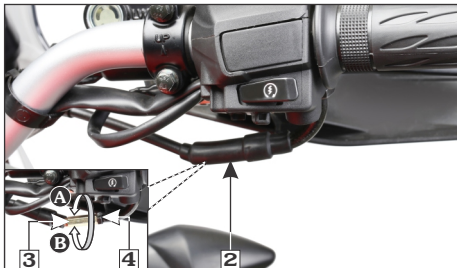

(2) Boot (3) Adjuster (4) Lock nut  
(A) Decrease free play (B) Increase free play

## DRIVE CHAIN SLACKNESS

The service life of the drive chain depends upon proper lubrication and adjustment.

Poor maintenance can cause premature wear or damage to the drive chain and sprockets.

The drive chain (1) should be checked and lubricated as part of the pre-ride inspection (page 36). Under severe usage, or when the vehicle is ridden in unusually dusty areas, more frequent maintenance will be necessary.

### Inspection

- Turn the engine “OFF”, park the vehicle on its main stand and shift the transmission to neutral.
- Drive chain slack (2) should be checked in the lower run midway between the sprockets. Move the drive chain up and down by hand and chain slack should be adjusted to 30–35 mm vertical movement by hand.



(1) Drive chain

(2) Drive chain slack: 30–35 mm

- Rotate the wheel and check the drive chain slack. Repeat this procedure several times. Drive chain slack should remain constant (30–35 mm). If the chain is slack only in certain sections, some links are kinked or binding. Binding and kinking can be eliminated by frequent lubrication.

### NOTE

**Drive chain slack should be adjusted at your Authorised Hero MotoCorp workshop as per the specification.**

- Turn the chain to view chain lock plate (3). Ensure that the chain lock plate open end (4) is installed in the opposite direction of the chain rotation.

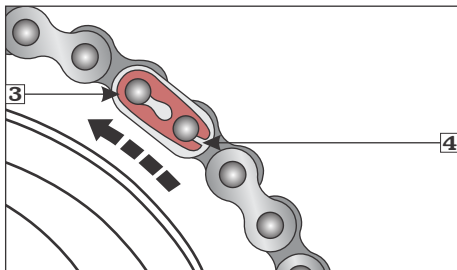

(3) Chain lock plate

(4) Open end

- Rotate the rear wheel slowly and inspect the drive chain and sprockets for any of the following conditions.

### Drive chain

- Damaged rollers
- Loose pins

- Dry or rusted links
- Kinked or binding links
- Excessive wear
- Improper adjustment
- Damaged or missing O-rings.

### Sprockets

- Excessively worn teeth
- Broken or damaged teeth.

If the drive chain has damaged rollers, loose links or missing O-rings, replace it. If the chain is dry or rusted, it should be lubricated. Lubricate the chain if the links are kinked or binding. If the problem is not solved after lubrication, replace the chain.

If the drive chain or sprockets are excessively worn or damaged, they should be replaced.

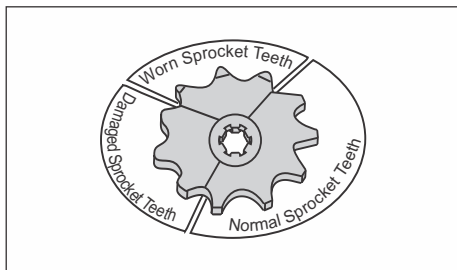

### ! CAUTION

**Always replace the drive chain and sprockets as a set. Otherwise the new part will wear prematurely.**

### Adjustment

Drive chain slack should be checked and adjusted, if necessary at every 700 km.

When operated at sustained high speeds or under conditions of frequent rapid acceleration, the chain may require more frequent adjustments.

If the drive chain requires adjustment, follow the procedures below:

- Park the vehicle on its main stand with the transmission in neutral and the ignition switch in "OFF" position.
- Loosen the rear axle nut (1).

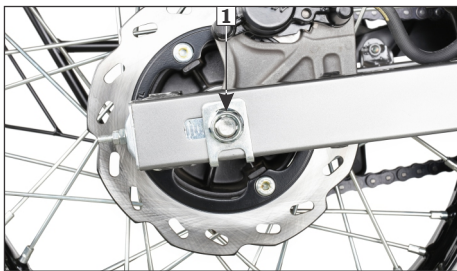

**(1) Rear axle nut**

- Loosen the drive chain lock nut (3).
- Turn the adjusting nut (4) in an equal number of turns until the correct drive chain slack is obtained. Turn the adjusting nut clockwise to decrease the slack or anticlockwise to increase the slack of the chain.

- Align the chain adjuster index mark (5) with the rear edge (6) of the adjusting slots on both sides of the swingarm equally.

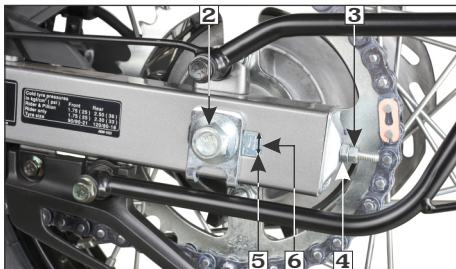

(2) Axle (3) Drive chain lock nut  
(4) Drive chain adjusting nut (5) Index mark  
(6) Rear edge of adjusting slot

- Tighten the rear axle nut.  
**Torque: 6.9 kgf-m**
- Check the drive chain slack again.
- If after adjustment of drive chain slack, axle (2) touches the rear edge of adjustment slot (6). Chain kit has to be replaced.

### WARNING

**If a torque wrench is not used for installation, see your Authorised Hero MotoCorp workshop as soon as possible to check for proper assembly.**

## Cleaning and Lubrication

Lubricate every 700 km or sooner if the chain appears dry.

- Turn the engine off, park the vehicle on its main stand and shift the transmission into neutral. Open side stand to facilitate cleaning.
- Spray a commercially available chain cleaner for cleaning the drive chain over its entire length.

### NOTE

**Ensure that the chain cleaner and lubricant used is the one recommended for use on an O-ring chain, otherwise the O-rings may deteriorate, fail and lose their sealing properties.**

- Rotate the rear wheel backwards to expose the next section of the drive chain and repeat second step until all of the drive chain is cleaned.
- Let the spray dry for about five minutes.
- To remove stubborn dirt, scrub the rollers and side plates with soft nylon brush.
- Apply SAE 90 grade oil on the hanger side of the entire length of the chain using an oil can.
- Wait for 7-10 minutes for penetration of lubricant inside the bush and roller wipe the excessive lubricant from the chain and nearby parts using a clean rag.

### NOTE

**Excessive lubricant if not wiped off, will aid in accumulation of dust, sand and dirt on the drive chain, increasing its wear and will also be sprayed on the vehicle as well due to chain movement.**

## ! CAUTION

- **Steam cleaning, high pressure washers and certain solvents can damage the drive chain O-rings.**
- **While lubricating and cleaning hold the rear wheel with one hand to prevent the possibility of your finger being trapped between the chain and sprocket.**
- **Clean and lubricate the chain, whenever possible, after riding the vehicle under rain or in terrain with excessive dust, mud or sand.**
- **The drive chain is fitted with O-rings between the link plates. These O-rings retain grease inside the chain to improve its service life. However, special precautions must be taken when adjusting, lubricating, washing and replacing the chain.**
- **If the chain is excessively dirty, it should be removed and cleaned before lubrication. For your own safety, we recommend that service be performed by an Authorised Hero MotoCorp workshop.**

### DRIVE CHAIN SLIDER INSPECTION

(Refer to “Maintenance Schedule” on **page 45**).

Check the chain slider (1) for wear, The chain slider must be replaced if wear limit is reached. For replacement, see your Authorised Hero MotoCorp workshop.

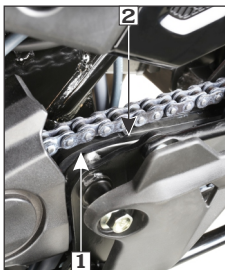

(1) Chain slider

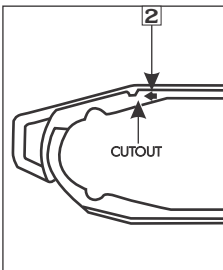

(2) Wear limit

### BRAKES

Refer to the safety precautions on **(page 44)**.

#### (a) Front brake

##### Master Cylinder/Reservoir (1)

**Location :** Right handlebar.

**Brake fluid recommended:**

DoT-4/DoT-3.

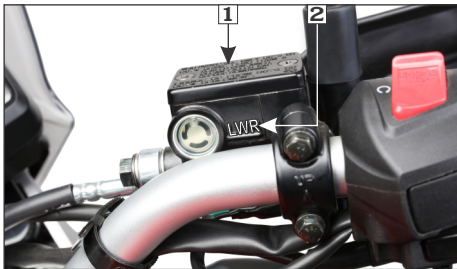

(1) Master cylinder/reservoir (2) Lower mark



**Fluid level** – Ensure that the brake fluid level does not fall below “LWR” (lower) mark (2) on master cylinder, when checked with the master cylinder parallel to the ground. The level decreases gradually due to piston movement to compensate pad wear. If the level decreases abruptly, check for the leakages in the brake system and consult your Authorised Hero MotoCorp workshop.

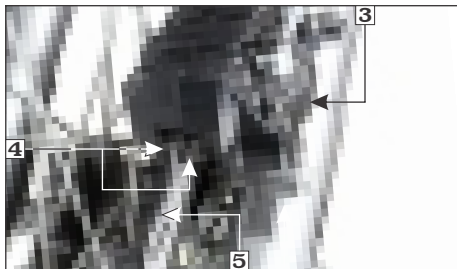

(3) Front brake caliper (4) Brake pad  
(5) Disc



#### NOTE

- *Clean the dirt and mud accumulation between the front brake caliper (3), brake pads (4) and the disc (5) by using a water jet.*
- *Always contact your Authorised Hero MotoCorp workshop for refilling of master cylinder/reservoir when necessary. Do not mix DoT 3 and DoT 4 brake fluid.*
- *Always use recommended tyres (page 64) for better braking performance.*

#### (b) Rear brake

Refer to the safety precautions on (page 44).

Reservoir (1)

Location : Near pillion footrest.

**Brake fluid recommended:**

DoT-4/DoT-3.

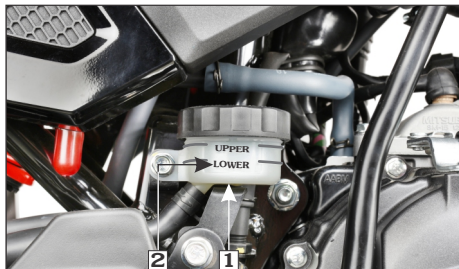

(1) Reservoir (2) “LOWER” mark

**Fluid level** – Ensure that the brake fluid level does not fall below “LOWER” mark (2) on the reservoir parallel to the ground. The level decreases gradually due to piston movement to compensate pad wear. If the level decreases abruptly, check for the leakages in the brake system and consult your Authorised Hero MotoCorp workshop.

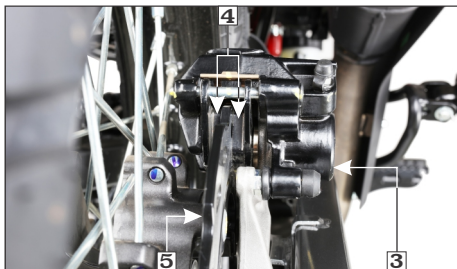

**(3) Rear brake caliper (4) Brake pads (5) Disc**

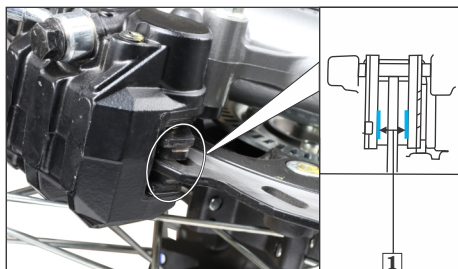

**(1) Wear indicator groove**



### NOTE

- *Clean the dirt and mud accumulation between the rear brake caliper (3), brake pads (4) and the disc (5) by using a water jet.*
- *Always contact your Authorised Hero MotoCorp workshop for refilling of reservoir when necessary. Do not mix DoT 3 and DoT 4 brake fluid.*

### (c) Brake pad wear

Brake pad wear depends upon the severity of usage, type of riding & road conditions. Generally, the pads will wear faster on wet & dirty roads. Inspect the pads at each regular maintenance interval.

#### Front brake

- Check the brake pads for wear by examining the wear indicator groove (1) on each pad.
- If either pad is worn to the bottom of the grooves replace both pads as a set. Visit your Authorised Hero MotoCorp workshop for this service.

### Rear brake

Check the wear indicator groove (1) in each pad.

If either pad is worn to the bottom of the groove, replace both as a set. Visit your Authorised Hero MotoCorp workshop for this service.

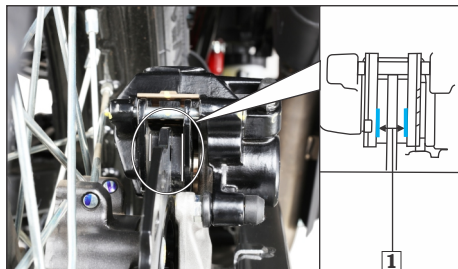

**(1) Wear indicator groove**

## **⚠ WARNING**

**Always apply front and rear brakes simultaneously to avoid skidding of vehicle.**

## **SUSPENSION**

### **Front and rear suspension inspection**

- Check the front forks by locking the front brake and pumping the front fork up and down vigorously. The suspension action should be smooth and there should be no oil leakage.



- Check the rear mono shock absorber by pushing hard downwards on rear grip while the vehicle is not parked on stand. The suspension action should be smooth and there should be no oil leakage.

### **Rear mono shock absorber adjustment**

Rear mono shock absorber adjustment can be made according to the load/road conditions.

- In direction A: Softer
- In direction B: Stiffer

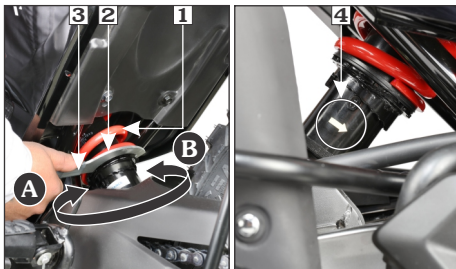

- (1) Rear mono shock absorber  
(2) Pin spanner (3) Pin spanner handle  
(4) Arrow mark sticker  
(A) Softer (B) Stiffer

## **NOTE**

- To adjust the rear mono shock absorber (1), use the rear shock absorber adjustment tool [Pin spanner (2) with handle (3)] available in the tool kit.
- Rear mono shock absorber arrow mark sticker (4) to be pointing towards vehicle front side during assembly on vehicle.

## **⚠ WARNING**

**This assembly contains high-pressure nitrogen gas. Any attempt to disassemble or refill this shock assembly may result in an explosion, causing serious injury. Exposure to flame or puncture may also result in an explosion. Replacement and disposal should only be done by your Authorised Hero MotoCorp workshop.**

## WHEEL

### (a) Front wheel

#### Removal

Refer to the safety precautions on (page 44).

- Support the vehicle securely on the main stand and raise the front wheel off the ground.
- Remove the wheel speed sensor bolt (1) from right fork leg and disconnect the wheel speed sensor (2).

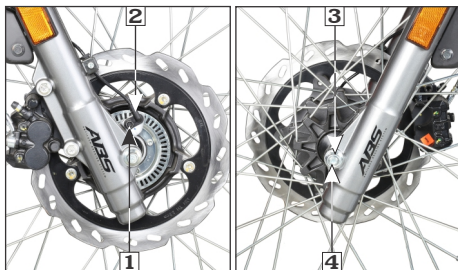

- (1) Wheel speed sensor bolt
- (2) Wheel speed sensor
- (3) Front axle nut
- (4) Axle

- Remove the front axle nut (3), remove the axle (4) and wheel.

#### ! CAUTION

**Do not operate front brake lever when the wheel is removed.**

- Remove the side collars (5) from both sides of the wheel.

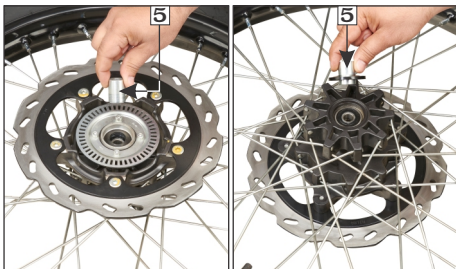

(5) Side collars

#### Installation

- Install the side collars (1) to both sides of the wheel hub.
- Insert the disc (2) between the pads in the caliper assembly (3). When installing the wheel, carefully fit the brake disc between the brake pads to avoid damage to the pads.
- Tighten the front axle nut (4) to the specified torque.

#### TORQUE : 6.0 kgf-m

- Install the wheel speed sensor (5).
- After installing the wheel apply the brake several times and then check if the wheel rotates freely. Recheck the wheel if the brake drags or if the wheel does not rotate freely.

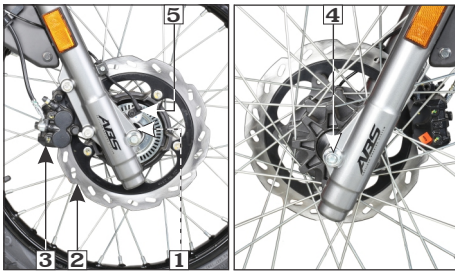

(1) Side collar (2) Disc (3) Caliper  
(4) Front axle nut (5) Wheel speed sensor

## (b) Rear wheel

### Removal

Refer safety precautions on (page 44).

- Support the vehicle securely on the main stand and raise the rear wheel off the ground.

- Remove the rear axle nut (1) and indicator plate (2).
- Remove the axle (3) and the right side collar (4).
- Move the caliper assembly (5) upwards.
- Remove the wheel.

### Installation

- Install the side collar (1) to the right side of the wheel hub.
- Position the rear wheel between the swingarm.
- Insert the disc (2) between the pads in the caliper assembly. When installing the wheel, carefully fit the brake disc between the brake pads to avoid damage to the pads.
- Align the rear caliper holder (3) with the swingarm (4).
- Insert the axle (5) from the left side through the swingarm, wheel hub, collar and rear caliper holder.

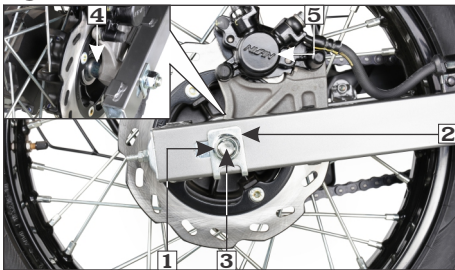

(1) Rear axle nut (2) Indicator plate (3) Axle  
(4) Side collar (5) Caliper assembly

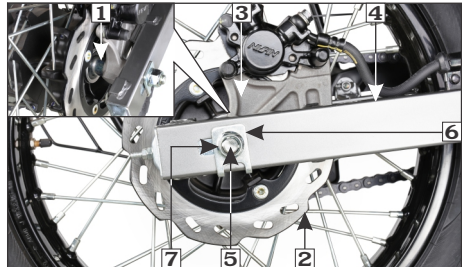

(1) Side collar (2) Disc (3) Caliper holder  
(4) Swingarm (5) Rear axle  
(6) Indicator plate (7) Rear axle nut

- Install the indicator plate (6) and tighten the rear axle nut (7) to the specified torque.

**TORQUE : 6.9 kgf-m**

- Adjust the drive chain slack (page 57).

### MAIN STAND (OPTIONAL)/ SIDE STAND LUBRICATION

- Park the vehicle on the level surface.
- Check the main/side stand return spring for damage or loss of tension.
- Check the main stand (1)/side stand (2) for freedom of movement.
- Lubricate the side stand.
- Make sure the main/side stand is not bent.

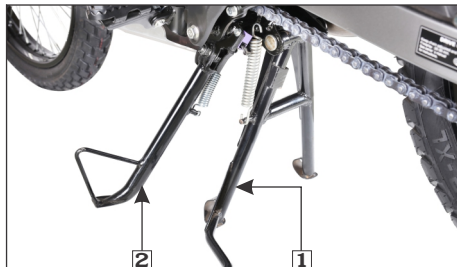

(1) Main stand (optional)      (2) Side stand

### TYRES

The tyres that are fitted on your vehicle are designed to match the performance capabilities of handling, braking, durability and comfort.

### NOTE

*The imported tyre(s) if fitted without ISI mark; are in compliance of BIS standard and Central Motor Vehicle Rules 1989, as declared by the Tyre manufacturer.*

To safely operate your vehicle, the tyres must be of recommended type and size, in good condition with adequate tread, and correctly inflated. The recommended tyres size is :

<b>Front</b>	90/90-21 M/C 54S
<b>Rear</b>	120/80-18 M/C 62S

### Air pressure

Properly inflated tyres provide the best combination of handling, tread life, and riding comfort. Generally, under inflated tyres wear unevenly, adversely affect handling, and are more likely to fail from being overheated.

Under inflated tyres can also cause wheel damage in rocky terrain.

Over inflated tyres make your vehicle ride more harshly, are more prone to damage from surface hazards and wear unevenly.

Make sure the valve stem caps are secure.

If necessary, install a new cap.

The recommended "cold" tyre pressure are:

	<b>Rider only</b>	<b>Rider and Pillion</b>
<b>Front</b>	1.75 kgf/cm <sup>2</sup> (25 psi)	1.75 kgf/cm <sup>2</sup> (25 psi)
<b>Rear</b>	2.30 kgf/cm <sup>2</sup> (33 psi)	2.50 kgf/cm <sup>2</sup> (36 psi)



(1) Air pressure gauge

**! CAUTION**

*Over inflation/Under inflation will affect the performance.*

### Inspection

Whenever you check the tyre pressure, you should also examine tyre treads & side walls for wear, damage & foreign objects:

Look for :

- Bumps or bulges in the side of the tyre or the tread. Replace the tyre if you find any bumps or bulges.
- Cuts, splits or cracks in the tyre. Replace the tyre if you can see fabric or cord.

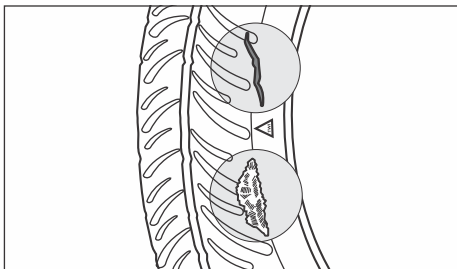

- Excessive tread wear.

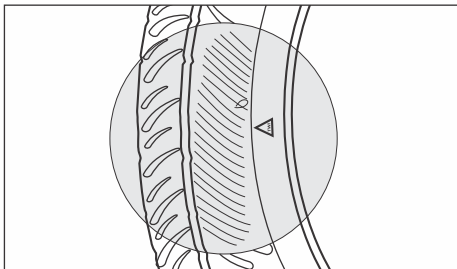

- Carefully inspect the tyres for any damage, if the vehicle hits a pothole or hard object.

### Tread wear

Replace tyres immediately when the tyres get worn upto the wear indicator (1) on the tyre. The tread limits are :

#### **MINIMUM TREAD DEPTH:**

**Front: 1.0 mm**

**Rear: 1.0 mm**

Check the tread wear indicator for tyre wear.

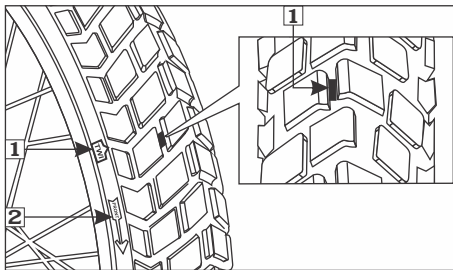

(1) Tread wear indicator

(2) Arrow mark

### Unidirectional tyres

Ensure the arrow mark (2) on the tyre is in the same direction as that of forward rotation of the wheel, whenever the tyre is removed and put back in case of puncture.

### WARNING

- *Using tyres that are excessively worn or improperly inflated can cause a crash in which you can be seriously hurt or killed.*
- *Operation with excessively worn tyres is hazardous and will adversely affect traction and handling.*
- *Follow all instruction in this owner's manual regarding tyre inflation and maintenance.*
- *Under-inflation may result in the tyre slipping on or tyre coming off the rim.*

- *Always use the size and type of tyres recommended in this owner's manual.*
- *Spoke tightness and wheel centering and alignment are essential for vehicle safety. During the first 1,000 km, the spokes become loose due to initial seating. Excessively loose spokes will cause instability at high speeds and possible loss of control.*
- *Inspect the spokes and wheel rims more frequently when the vehicle is ridden in rough terrain.*

### NUTS, BOLTS & FASTENERS

- Tighten bolts and nuts at regular interval shown in the maintenance schedule.
- Check that all chassis nuts and bolts are tightened to correct torque values.
- Check that all cotter pins, safety clips, hose clamps and cable stays are in place.





## BATTERY

Refer to the safety precautions on (page 44).

### Location

The battery is located behind the left side cover.

### Specification

\*MF Battery-12V-6 Ah/ETZ-7

It is not necessary to check the battery electrolyte level or add distilled water as the battery is a **Maintenance-Free (sealed)** type. If your battery seems weak and/or electrolyte is leaking (causing hard starting or other electrical troubles), contact your Authorised Hero MotoCorp workshop.



### NOTE



*This symbol on the battery means that this product must not be treated as household waste.*



*This symbol on the battery means the old battery must be returned to your Authorised Hero MotoCorp workshop as it must be treated as recyclable material.*

- **Battery is a maintenance-free (sealed) type and can be permanently damaged if the sealing strip is removed.**
- **An improperly disposed battery can be harmful to the environment and human health. Always confirm local regulations for battery disposal.**

### Battery charging

Always visit your Authorised Hero MotoCorp workshop if you see any symptom of battery discharge as earliest as possible to get the battery charged. The battery has a tendency to discharge rapidly if additional electrical accessories are fitted on the vehicle.

### Battery storage

- If in case your vehicle is not used for more than a month remove the battery, fully charge and store in a cool and dry place.
- If the battery is expected to be stored for more than two months, ensure to fully charge the battery once in a month.
- Always ensure the battery is fully charged before installation.
- Ensure the battery leads are properly connected to the battery terminals during installation.

### Battery removal

- Make sure the ignition switch is “OFF” (⊗).
- Remove the seat (page 35).
- Remove the right side cover screws (1), side cover (2) by releasing the lug from the grommet (3) and slide the cover towards the rear to release tab from the slot (4).

\*MF stands for Maintenance Free

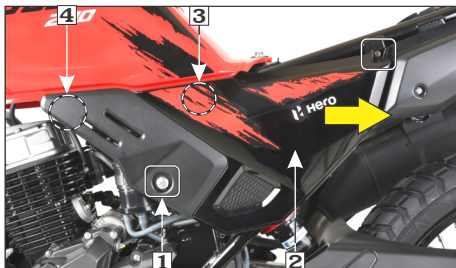

(1) Right side cover screws (2) Side cover  
(3) Lug/Grommet (4) Tab/Slot

- Disconnect the (-)ve terminal lead (5) from the battery first, then disconnect the (+)ve terminal lead (6).
- Remove the battery clamp bolt (7) and the battery clamp (8).

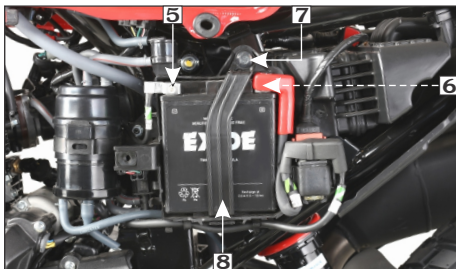

(5) (-)ve terminal (6) (+)ve terminal  
(7) Battery clamp bolt (8) Battery clamp

- Pullout the battery (9) from the battery box.



(9) Battery

### Battery installation

- Reinstall in the reverse order of removal. Be sure to connect the (+)ve terminal first, then the (-)ve terminal.
- Check all bolt and other fasteners are secure properly.

### FUSE REPLACEMENT

Refer to the safety precautions on (page 44).

#### Fuse box (1)

**Location:** Below the seat.

#### Fuse type: Blade fuse

Main fuse (2) : 15A, 10A, 10A and 10A

Spare fuse (3) : 15A and 10A

### ⚠ WARNING

- *Never use a fuse with a different rating from that specified. It may lead to serious damage to the electrical system or a fire due to short circuit.*
- *Battery gives off explosive gases. Keep sparks, flames & cigarettes away.*

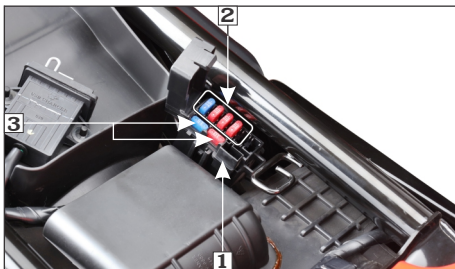

- (1) Fuse box
- (2) Main fuse :15A, 10A, 10A and 10A
- (3) Spare fuse:15A and 10A

### Starter magnetic switch (4)

**Location:** Inside left side cover, below the starter magnetic switch.

### Fuse type: Blade fuse

Main fuse (5) :20A

Spare fuse (6) :20A

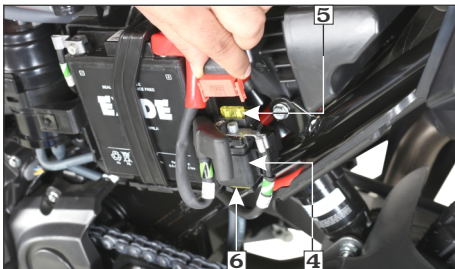

- (4) Starter magnetic switch
- (5) Main fuse:20A      (6) Spare fuse:20A

## ! CAUTION

- Do not attempt to start or ride the vehicle without a charged battery, it can cause fusing of the bulbs and permanent damage to certain electrical components.
- Turn the ignition switch "OFF" before checking or replacing the fuse to prevent accidental short-circuiting.

GOOD FUSE

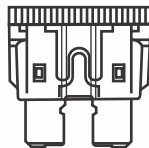

BLOWN FUSE

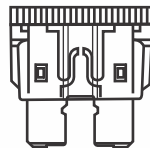

### STOP LAMP SWITCH

The stop lamp switch (1) must be adjusted so that stop lamp glows when rear brake is applied. The procedure for adjusting stop lamp is as follows :

- Turn the ignition switch to the "ON" (O) position.
- Turn the adjusting nut (2) to position stop lamp switch at a point where the stop lamp glows once the brake pedal is depressed. Turn the adjusting nut in direction (A) to advance switch timing or in direction (B) to retard switch timing.

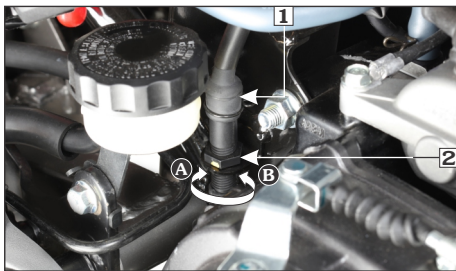

(1) Stop lamp switch      (2) Adjusting nut  
(A) Advance                (B) Retard

## HEADLAMP FOCUS ADJUSTMENT

Headlamp is factory pre-set. However in case of adjustment required, please follow the steps as given below:

- Headlamp adjustment is done by loosening the bolts (1) located on both the sides of the headlamp assembly.

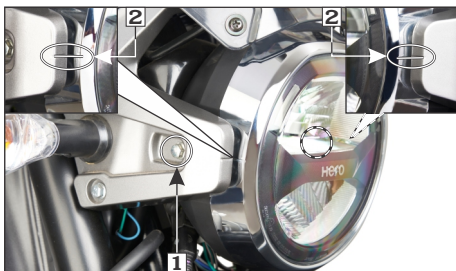

(1) Adjusting bolts      (2) Index marks

- Park the vehicle on the level ground.
- Turn the ignition switch to “ON” (ⓐ) position and start the engine.
- Adjust the headlamp by loosening the bolts (1) and moving the headlamp assembly up and down for correct focus adjustment.
- Align the headlamp casing index marks (2) to the index mark on the headlamp assembly cover.
- After adjusting the headlamp, tighten the headlamp adjusting bolt.

### **⚠ WARNING**

*An improperly adjust headlamp may blind oncoming rider/driver or it may fail to light the road for a safe distance.*

## CATALYTIC CONVERTER

This vehicle is equipped with a catalytic converter (1) in the muffler to meet the emission norms.

The catalytic converter contains precious metals that serve as catalysts, promoting chemical reactions to convert the exhaust gasses without affecting the metals. The catalytic converter acts on HC, CO and NOx.

The catalytic converter must operate at a high temperature for the chemical reactions to take place. It can set on fire any combustible material that come near it. Park your vehicle away from high grasses, dry leaves, or other flammable material.

A defective catalytic converter contributes to air pollution and can impair your engine's performance.

Follow these guidelines to protect your vehicle's catalytic converter.

- Always use unleaded petrol. Even a small amount of leaded petrol can contaminate the catalyst metals, making the catalytic converter ineffective.
- Keep the engine tuned up.

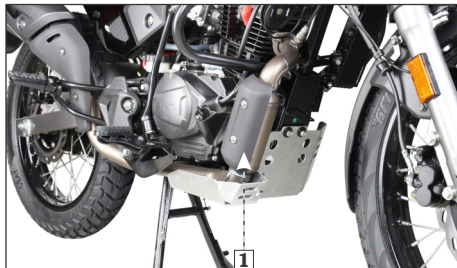

**(1) Catalytic converter**

## EVAPORATIVE EMISSION CONTROL SYSTEM

This vehicle is equipped with an evaporative emission control system to meet emission standards. During warm weather, the petrol vapours which contain HC evaporates easily into the atmosphere from the fuel tank, if the fuel system is unsealed or open.

The evaporative emission control system is used to prevent petrol vapours from escaping into the atmosphere from fuel tank.

The canister (1) collects the fuel vapour from the fuel tank and then the fuel vapour is drawn into the engine for re-burning to avoid pollution caused by the fuel vapour diffused into the air.



**(1) Canister**

## POLISHING OF VEHICLE

After washing your vehicle, wax all painted surfaces (except matte painted surfaces) using a commercially available polish/quality liquid or paste wax to finish the job. Use only a non abrasive polish or wax made specifically for automobiles. Apply the polish or wax according to the instructions on the container.



### NOTE

***Polishing or waxing is not applicable for models having matte paint.***

## BASIC TROUBLESHOOTING

### 1. STARTING TROUBLE - ENGINE DOES NOT START

#### A. Engine Stop/Kill Switch Position



**Consult Authorised Hero MotoCorp Workshop**

#### B. Side Stand Engine Kill System



**Consult Authorised Hero MotoCorp Workshop**

#### C. Fuel System

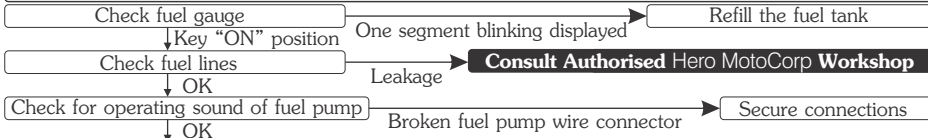

**Consult Authorised Hero MotoCorp Workshop**

#### D. Electric Starter Not Working

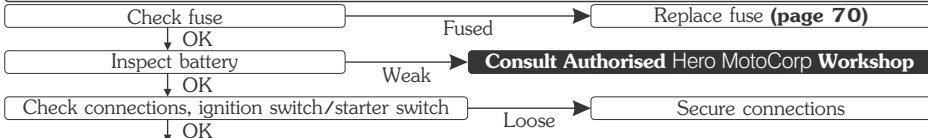

**Consult Authorised Hero MotoCorp Workshop**

## BASIC TROUBLESHOOTING

### D. No Spark At Spark Plug

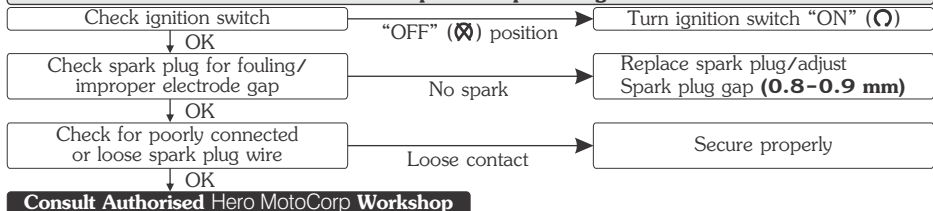

### 2. ENGINE STARTS BUT STALLS



### 3. POOR PICK UP

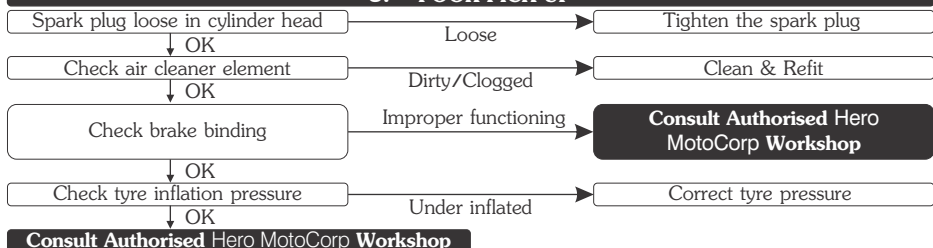

## BASIC TROUBLESHOOTING

### 4. ELECTRICAL SYSTEM

#### Feeble Horn Sound or No Light

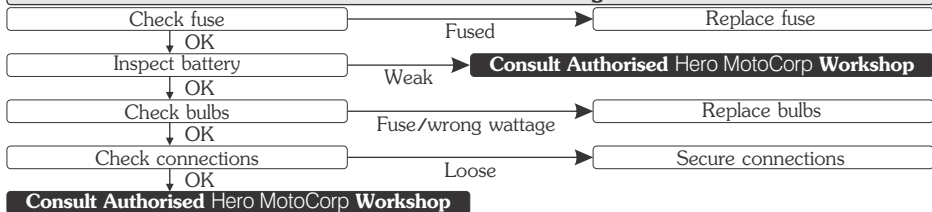



## ROAD SIGNS



**Mandatory signs:** These road signs inform drivers/riders of the traffic rules that apply on a certain stretch of road, thereby instructing them on how to drive/ride. Mandatory signs are distinguished by the bright red circle with black and blue markings. It is imperative that all riders follow these signs as they help avoid accidents. Their violation can be penalised under the Motor Vehicle Act.

### Mandatory



Stop

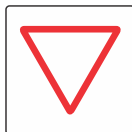

Give Way



One Way



No Horn



No Bicycles



No Automobiles



No Hand Craft



No Pedestrians



No Right Turn



No 'U' Turn



Overtaking Prohibited



Speed Limit

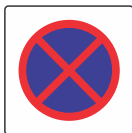

No Stopping  
or Standing

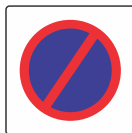

No Parking



Length Limit



High Limit



Restriction Ends



Compulsory-  
Ahead Only

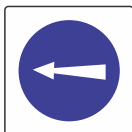

Compulsory-Turn  
Left



Compulsory-Right  
Ahead



Compulsory-Ahead  
or Turn Right

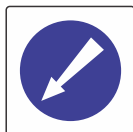

Compulsory-Keep  
Left



Compulsory-Bicycle  
Track



Compulsory-Sound  
Horn

## ROAD SIGNS



**Cautionary signs:** These signs inform the driver/rider of the road conditions ahead. Cautionary signs therefore serve as a warning. They are usually in a red triangle with black pictures on a white background. Illustrations, diagrams and symbols are used to forewarn about dangers ahead. Cautionary road signs are as important as mandatory signs. However, the violation of cautionary signs does not attract penalty.

### Cautionary



Right Hand Curve



Right Reverse Bend



Incline Ahead



Narrow Road Ahead



Narrow Bridge



Pedestrian Crossing



School Ahead



Gap in Medium



Cross Road



Men at Work



Roundabout



Hump Road

## ROAD SIGNS



**Informatory signs:** These are facility signs that provide important information about road directions are maps of specific destinations. On highways, they provide information about the location of public telephones, restaurants, hospitals, parking, petrol pumps, resting-places and more. These signs are usually rectangular, with black or white pictures on a blue background.

### Informatory



Destination Sign



Hospital



First Aid Post



Petrol Pump



Eating Place



Resting Place



Public Telephone



Place Identification Place



Light Refreshment



Taxi Stand



Parking Both Sides



Parking This Side



No Through Road



No Through Side Road



Re-assure Sign

Signs and Signals are language of the road. Learn them, respect them.

## NAVIGATION SIGNS

**Navigation signs:** Hero navigation app. and meter console of your vehicle will display step by step navigation guidance/direction through below navigation signs when your vehicle is in navigation mode with your smartphone.

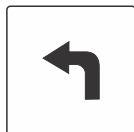

Turn Left

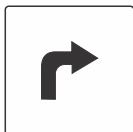

Turn Right

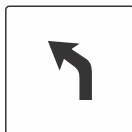

Turn Slight Left

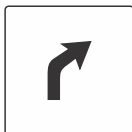

Turn Slight Right



Turn Sharp Left



Turn Sharp Right



Straight

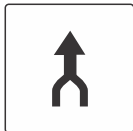

Merge

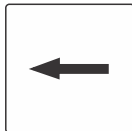

Keep Left

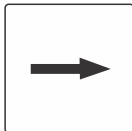

Keep Right

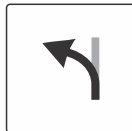

Ramp Left

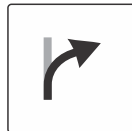

Ramp Right



Round About  
Left

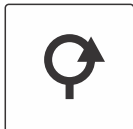

Round About  
Right

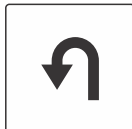

U Turn Left

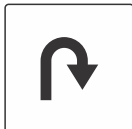

U Turn Right

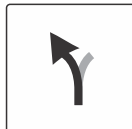

Fork Left



Fork Right



Ferry



Ferry Train

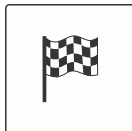

Destination  
Reached

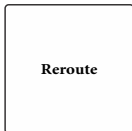

Wrong way



# Hero MotoCorp Ltd.

## WARRANTY

### Scope of warranty

Hero MotoCorp Ltd. (hereinafter called 'Hero MotoCorp') warrants its **XPULSE 200 PROGRAMMED FI** vehicles, assembled/manufactured in its Plants and sold through its channel partners, to be free from any defect – both in material and workmanship, under normal use and conditions, subject to the following terms & conditions.

### Terms & conditions

- a) **XPULSE 200 PROGRAMMED FI** vehicle is warranted for a period of **5 years or 70000 Km**, whichever is earlier, from the date of purchase, emission warranty is separately covered under the head of "Emission Warranty".
- b) It is advised that the purchaser avails all free and paid services from the Hero MotoCorp's authorized workshop as per the recommended schedule, to be eligible for warranty benefits. Each paid service should be availed within **90** days from the date of previous service or as per the recommended schedule, whichever is earlier.
- c) If any problem is observed in **XPULSE 200 PROGRAMMED FI** vehicle, Hero MotoCorp's only obligation/ liability is to repair or replace that part/those parts which is/are considered to be the cause of such problem, provided however that such problem has not resulted due to misuse/improper handling etc. of the vehicle. Any **XPULSE 200 PROGRAMMED FI** vehicle needing repair should be brought along with owner's manual to Hero MotoCorp's authorized workshop for necessary inspection and carrying rectification job.



# Hero MotoCorp Ltd.

## LIMITATIONS OF WARRANTY

### The warranty shall not apply—

- (1) If all free services/paid services/oil top-ups are not availed as per the recommended schedule at Hero MotoCorp's authorized workshop.
- (2) If any other engine oil which is non compatible with product is used other than SAE 10W30 SL Grade (JASO MA2).
- (3) To normal wear & tear components including (but not limited to) brake shoes/pads, clutch plates, drive chain & sprockets, bulbs, electrical wiring, filter, spark plug, fasteners, shims, washers, oil seals, gaskets, rubber parts, bush, rubber bellows, plastic parts breakage, wheel rim for misalignment/bend, steering ball race & cone, control cables such as brake cable/clutch cable, fuses (all types), steering handle for bend and sticker peel off.
- (4) If additional wheel(s) is/are fitted and/or any other modification carried out/unauthorized accessories fitted which shall be responsible for malfunction/deterioration of the vehicle.
- (5) If **XPULSE 200 PROGRAMMED FI** vehicle has been used in any competitive events like races or rallies or for any commercial purposes as taxi etc.
- (6) To any damage on vehicle's painted surface cropping due to industrial pollution or other external factors.
- (7) For normal phenomena like noise vibration, oil seepage etc., which do not affect the performance of the vehicle.
- (8) To any damage caused due to usage of improper oil/grease, non-genuine parts.
- (9) If any defect crops or repairs needed as a result of using adulterated fuel.
- (10) If any maintenance/repairs required due to bad road conditions or misuse of **XPULSE 200 PROGRAMMED FI** vehicle.
- (11) If any defect crops or repairs needed as a result of **XPULSE 200 PROGRAMMED FI** vehicle meeting to some accident.
- (12) For consumables like oil, grease, gasket etc to be used during free services and/or warranty repairs.
- (13) To any part of the **XPULSE 200 PROGRAMMED FI** vehicle which has been tampered or repaired in such a manner which has resulted in malfunction of the vehicle.
- (14) For **XPULSE 200 PROGRAMMED FI** vehicle not used in accordance with the guidelines given in this Owner's Manual.
- (15) To proprietary items like Tyres, Tubes, Batteries, etc, as they are subjected to the warranty terms & conditions of respective manufacturers and directly handled by them only.
- (16) Any defect(s) developing on account of external factors such as environmental factors; including but not limited to fading/peeling/rusting of paint and/or stripes and/or plated parts, seat leather tearing & cracking, aluminium parts oxidation and cracking & discoloring of control switches etc.

**Decision regarding warranty settlement shall be taken by Hero MotoCorp and the same shall be final and binding on all concern.**

**Subject to DELHI JURISDICTION only.**



# Hero MotoCorp Ltd.

## **BATTERY WARRANTY PERIOD**

1. 18 months from date of sale of vehicle or 20000 km. or
2. 21 months from the date of charging (whichever is earlier).
3. 3 months idle period is allowed from the date of charging to date of sale on vehicle.

## **Terms and condition of warranty**

1. Batteries are warranted against all defects in material and workmanship. Liability under this warranty is limited to making good of defects rising solely from the use of faulty material or workmanship during manufacturing and developing under proper use. The warranty commences from the date of delivery to the original purchase of the vehicle.
2. In the event of any complaint the battery is to be returned complete with electrolyte to nearest battery service station or any OEM dealer. On inspection, battery would be returned or replaced.
3. This warranty card accompanies a battery sold as OEM fitment only. Claims should be supported with vehicle purchase invoice to enable processing.
4. The right to determine whether a battery needs repair or totally replacement lies with the company. In case where the battery is replaced, the defective battery becomes the property of the company and no scrap rebate will be given for it. The warranty period on the battery being repaired/replaced shall commence from the date of sale of the original battery as stated in the original warranty card.
5. All liabilities under this warranty will cease if the battery is used on the vehicle other than that on which the battery was originally fitted and on the expiry of the warranty period as mentioned above.
6. Recharging is not covered under the purview of this warranty and shall be billed as extra. However, FOC battery replacement/repair includes cost of charging.
7. This warranty does not cover damage to the battery caused by faulty electrical systems, incorrect charging and filling, improper handling of the battery by unauthorized dealers/auto electricians, maintenance, willful abuse, destruction by fire, collusion, theft or recharging.
8. Breakage of container and cover do not come under the purview of this warranty.
9. Adjudication and settlement of claim will take a couple of days as a battery has to be tested for the reported failure.
10. In case of tempering of the original wiring circuit in any manner whatsoever.
11. If a battery which is not recommended is fitted on the vehicle then such battery will not carry any warranty.
12. The applicable taxes which is leviable on the battery under repair or replacement will be borne by the customer.
13. Customers are deemed to have read, understood and agreed to these conditions at the time of purchase of the vehicle.



# Hero MotoCorp Ltd.

## EMISSION WARRANTY

### Scope of warranty

Hero MotoCorp Ltd. Warrants all its vehicles, assembled/manufactured at its various Plants and sold through its channel partners, to comply with emission standards as specified in sub rule (2) of Rule 115 of Central Motor Vehicles Rules, 1989, subject to following terms & conditions.

### Terms & conditions

- a) The emission warranty shall be applicable in India and shall remain valid for a period of 3 years or 30000 km, whichever occurs earlier, from the date of vehicle purchase.
- b) In case any defect is observed in any emission-related component which are covered under emission warranty, Hero MotoCorp only obligation/liability shall be to repair and/or replace those part (s) which is/are considered to be the cause of non-compliance with the emission standards.
- c) The method (s) of examination to determine the warranty conditions of the emission warranty related component will be at the sole discretion of Hero MotoCorp Ltd. and / or Channel Partners / service center and result of such examination shall be final and binding. If on examination the warranty conditions of the part (s) is / are not established, Hero MotoCorp Ltd. will have the right to charge all, or part of the cost of such examination / service charges to the customer in addition to the cost of the components.
- d) Hero MotoCorp Ltd. shall have the sole discretion to decide to replace the defective components or the entire assembly or any other part required for such repair.
- e) The emission warranty shall be applicable only to those vehicles, which are being regularly maintained in accordance with the maintenance schedule provided in the owner's manual.
- f) The customer should follow the recommended parts replacement as per the maintenance schedule in order to avail the emission warranty.
- g) If any part (s) related to emission characteristics of the vehicles is/are tampered and/or repaired by unauthorized person/workshops etc, then the emission warranty shall stand cancelled.
- h) Any part (s) suffering wear and tear under the normal course of running shall not be covered under the emission warranty. Therefore, all such parts should be replaced by the customer from time to time, on payment basis, as per the maintenance schedule provided in owner's manual and dealer's advice
- i) It is recommended to avail the services as per the recommended schedule to be eligible for the emission warranty benefits. Please ensure that each paid service is availed within 90 days from the date of previous services or as per the recommended schedule, whichever is earlier. All service details should be completely filled by the dealer, in the **Service Record Sheet** given in the owner's manual.



# Hero MotoCorp Ltd.

## EMISSION WARRANTY

- j) It is mandatory to obtain a PUC certificate from the Authorised PUC center. In case of non-compliance with the emission standards please contact the channel partner/authorised workshop immediately along with the previous OK certificate, for the necessary rectification. The manufacturer or the dealer is not responsible for any penalty levied on you on account of non-compliance with the emission standards.
- k) The parts, which are covered under emission warranty are fuel injector, fuel pump, throttle body, ignition coil, oxygen sensor and muffler.
- l) Emission warranty shall not be applicable if
- The vehicle has been subjected to abnormal use, abuse, neglect and improper maintenance or has met with an accident.
  - The vehicle, or parts thereof, has been altered, tampered with or modified or replaced in an unauthorized manner.
  - The odometer is not functioning or the odometer and/or its reading has been changed/tampered with, so that the actual distance covered cannot be readily determined.
  - The vehicle has been used for competitions, races, and rallies or for the purpose of establishing records.
- m) All decisions regarding emission warranty settlement shall be taken by Hero MotoCorp Ltd. and shall be final binding on all concerned.

**Subject to Delhi jurisdiction only.**





## WHAT ARE THE BENEFITS OF Hero MotoCorp GENUINE SPARE PARTS ?

- Assures long life
- Ensures economy for a long time
- Safety of vehicle and rider
- Peace of mind
- Value for money
- Assured quality

## CONSEQUENTIAL DAMAGES ON USING NON-GENUINE PARTS

<b>Clutch Plate</b>	<ul style="list-style-type: none"><li>• Material used is inferior</li><li>• Damages other parts of clutch like, clutch center and outer clutch</li><li>• Affects fuel efficiency</li><li>• Poor acceleration</li></ul>
<b>Cam Chain Kit</b>	<ul style="list-style-type: none"><li>• Poor performance</li><li>• Reduced life</li></ul>
<b>Gasket Cylinder Head</b>	<ul style="list-style-type: none"><li>• Improper sealing</li><li>• Engine knocking</li><li>• Leads to leakage and smoky exhaust</li><li>• Higher emission level</li></ul>



### CONSEQUENTIAL DAMAGES ON USING NON-GENUINE PARTS

<b>Element Air Cleaner</b>	<ul style="list-style-type: none"><li>• Improper air filtration resulting in premature engine failure</li><li>• Affects fuel efficiency</li><li>• Poor engine performance</li></ul>
<b>Spark Plug</b>	<ul style="list-style-type: none"><li>• Frequent stalling of engine</li><li>• Higher emission level</li><li>• Poor engine performance</li><li>• Affects fuel efficiency</li></ul>
<b>Brake Pads/Shoes</b>	<ul style="list-style-type: none"><li>• Poor braking efficiency</li><li>• Rider safety-an issue</li><li>• Discs/Drum wear out, resulting in subsequent repair cost</li></ul>
<b>Chain Sprocket Kit</b>	<ul style="list-style-type: none"><li>• Noisy Operation</li><li>• Failure of chain can cause fatal accident</li></ul>

## ZONAL/REGIONAL/AREA OFFICES

**For any of your service related query/requirements you may contact the respective Zonal/Regional/Area Offices**

### CENTRAL ZONE

**Hero MotoCorp Ltd.**, No. 209-210, Ganpati Plaza, M.I. Road, Jaipur-302001, (Rajasthan).  
Tel: +91 141 2389031, +91 141 2389156, E-mail: jaipur@heromotocorp.com

**Hero MotoCorp Ltd.**, Office No. 705-706, 7th Floor, Fun Square, Durga Nursery Road, Udaipur -313001 (Rajasthan).  
Tel: +91 0294-2980578, 79, E-mail: udaipur@heromotocorp.com

**Hero MotoCorp Ltd.**, Office.No.401, 4th Floor, Offizo, Magneto Mall, Labhandi, G.E. Road, Raipur -492 001, (Chhattisgarh)  
Tel: +91-771-4034749, E-mail: raipur@heromotocorp.com

**Hero MotoCorp Ltd.**, Third Floor, Alankar Palace, Plot No. 11, Zone II, M.P. Nagar Bhopal-462011, India.  
Tel: +91-755-4203160, 2553697, 4272429, 2550086, E-mail: bhopal@heromotocorp.com

**Hero MotoCorp Ltd.**, Maloo-01, 601-602, 6th Floor, Plot No. 26C, Scheme No. 94, Ring Road, Indore, M.P.-452010,  
Tel: +91-731-4978269, 70, E-mail: indore@heromotocorp.com

### EAST ZONE

**Hero MotoCorp Ltd.**, Flat No: 1002, 10th Floor, Martin Burn Business Park, BP3, Salt Lake, Sector-V, Kolkata-700091, West Bengal, India. Tel: +91-33-44026841, +91-33-44026830, E-mail: kolkata@heromotocorp.com

**Hero MotoCorp Ltd.**, Odysa Business Centre, Plot no. 30, 30/982, 172/1030, 4th Floor Cuttack, Bhubaneswar highway road, Rasulgarh, Bhubaneswar-751010, Odisha, India. Tel: +91-674-2581161, 62, 63, 64, E-mail: bhubaneswar@heromotocorp.com

**Hero MotoCorp Ltd.**, Yash Heights, 1st Floor Bariatu Road, Above Basudeh Tata Showroom Ranchi-834009, Jharkhand, India. Tel: +91-651-2542222, 2542224, 2542225, E-mail: ranchi@heromotocorp.com

**Hero MotoCorp Ltd.**, Sai Corporate Park, A Block, 6th Floor, Rukanpura, Bailey Road Patna, Bihar - 800014  
Tel: +919334280555/7004569648 E-mail: patna@heromotocorp.com

### NORTH ZONE

**Hero MotoCorp Ltd.**, 3rd Floor, Tower-A, DLF Centre Court, Sector-42, Golf Course Road, DLF Phase 5, Gurgaon -122002, Haryana, India. Tel: 0124-4754800, E-mail: delhi@heromotocorp.com

**Hero MotoCorp Ltd.**, 602, 6th Floor, Office Tower-1, Plot No BW58, Logix City Center, Sector-32, Noida - 201301.  
Tel: 0120-4631000, E-mail: noida@heromotocorp.com

**Hero MotoCorp Ltd.**, S.C.O-367-368, First Floor, Sector-34A, Chandigarh-160022, India.  
Tel: +91-172-2623773, 2623774, 2623775, E-mail: chandigarh@heromotocorp.com

**Hero MotoCorp Ltd.**, Kapoor Towers, Plot No- 284, 15-B, Rajpur Road, Dehradun-248001, India.  
Tel:0135-2714661,2713662,2714663, E-mail: dehradun@heromotocorp.com

## ZONAL/REGIONAL/AREA OFFICES

### NORTH ZONE

**Hero MotoCorp Ltd.**, Summit Building (10th Floor) Plot No TCG 3/3 Vibhuti Khand, Gomti Nagar Lucknow – 226010, India. Tel: 0522-4006594, E-mail: lucknow@heromotocorp.com

**Hero MotoCorp Ltd.**, C-19/134-B, Third Floor I.P Grand, Lallapura, Siga, Varanasi, Uttar Pradesh – 221010, India. Tel: +91-0542- 2390949, 2390241, E-mail: varanasi@heromotocorp.com

### SOUTH ZONE

**Hero MotoCorp Ltd.**, SKAV 909, 3rd Floor, 9/1, Lavelle Road, Bangalore–560001, India. Tel: +91-80- 46881000, E-mail: bangalore@heromotocorp.com

**Hero MotoCorp Ltd.**, 3-6-289, 3rd Floor, Kareem Manzil, Hyderguda, Hyderabad–500029, India. Tel: +91-40-23223735, 23223727, 23223570, E-mail: hyderabad@heromotocorp.com

**Hero MotoCorp Ltd.**, 9th Floor Seshachalam Centre No.636/1, Anna Salai, Nandanam, Chennai–600035, India. Tel: +91-44- 24340974, 24340977, 24340978, E-mail: chennai@heromotocorp.com

**Hero MotoCorp Ltd.**, 6-A, DD Trade Tower, (6th Floor), Kaloor-Kadavanthra Road, Kaloor–682 017, Kochi–682017, India. Tel: +91-0484- 4039646 –7, E-mail: cochin@heromotocorp.com

**Hero MotoCorp Ltd.**, No 1547, 2nd Floor Classic Towers, Trichy Road, Coimbatore – 641018  
Tel: +91-422-2200058, 2200061, E-mail: coimbatore@heromotocorp.com

**Hero MotoCorp Ltd.**, First Floor VA Kalburgi Mahalakshmi Mansion, Mandakini Hospital Road, New Cotton Market, Hubli–580029, India. Tel: 0836-2269717, 2361038, E-mail: hubli@heromotocorp.com

**Hero MotoCorp Ltd.**, D.NO. 54-11-18 E, 2nd Floor, Sai Oddessey Building, Opp Executive Club, Near NH-5, Vijayawada–520008, Andhra Pradesh, India. Tel: +91-866-2546859, 2546860, E-mail: vijayawada@heromotocorp.com

### WEST ZONE

**Hero MotoCorp Ltd.**, Chrome Building, Sr. No. 33, Hissa-A-1/1/2, Plot – 2, Viman Nagar Avenue 2, Nagar Road, Pune-411014, India. Tel: +91-020-71903500, E-mail: pune@heromotocorp.com

**Hero MotoCorp Ltd.**, 603-604, Gunjan Tower, Off Alembic Gorwa Road, Baroda–390023, India. Tel: +91-265-2286569/2286570, E-mail: baroda@heromotocorp.com

**Hero MotoCorp Ltd.**, Ground Floor, Block No.2, Vishnu Vaibhav Complex, 222, Palm Road, Civil Lines, Nagpur–440001 India. Tel: +91-712-2545990-91, E-mail: nagpur@heromotocorp.com

**Hero MotoCorp Ltd.**, Astarc House-Third Floor, 76/79, Makwana Lane, Off. Andheri-Kurla Road, Andheri (East), Mumbai-400059, India. Tel: +91-22-28562071, E-mail: mumbai@heromotocorp.com

**Hero MotoCorp Ltd.**, 604, Kings Plaza, Astron Chowk, Rajkot, Gujarat – 360001  
Tel: 0281-2460622, 2460623, E-mail: rajkot@heromotocorp.com